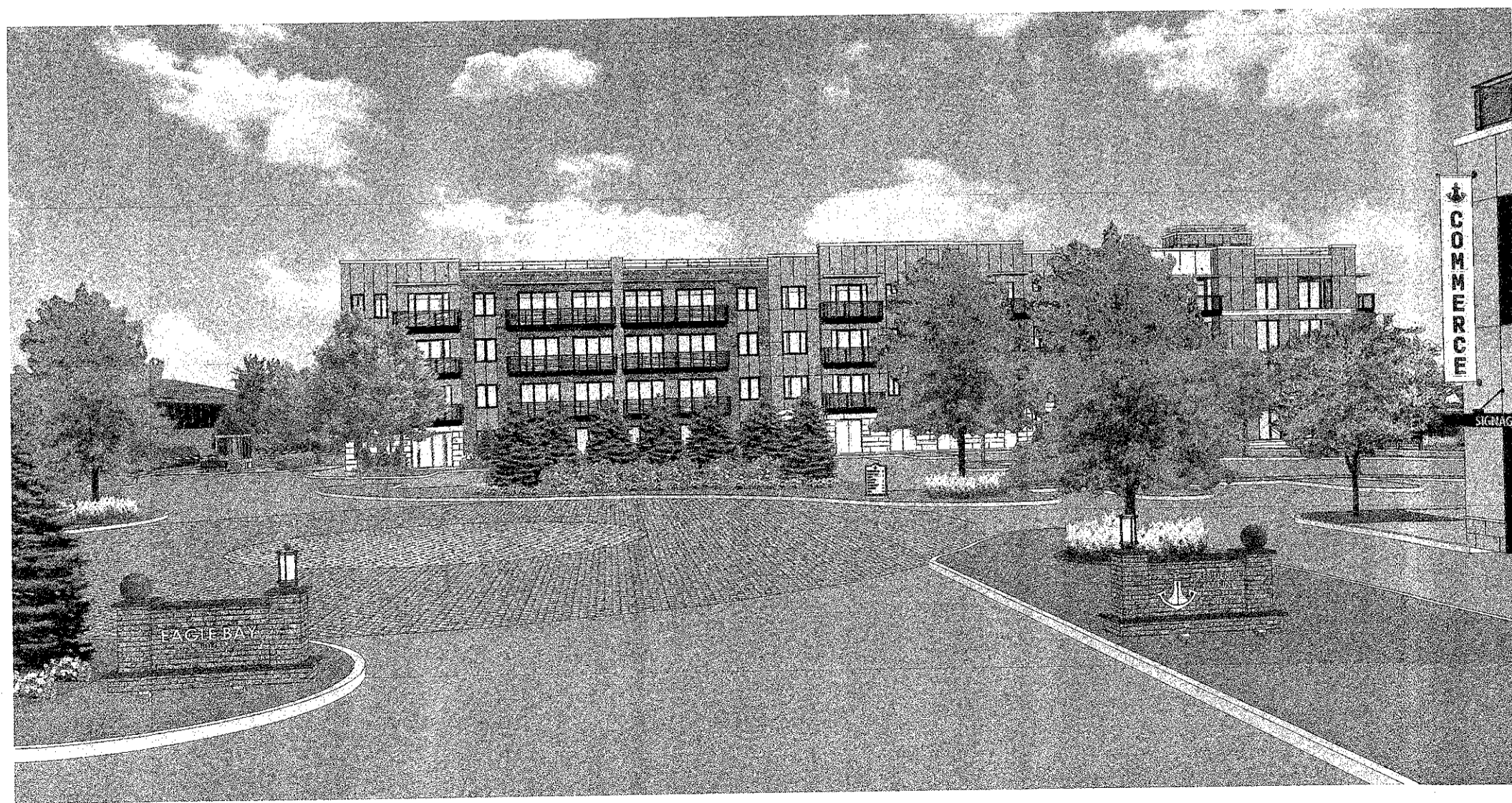

TABLE OF CONTENTS	
L-1	LANDSCAPING PLAN AREA 'K' - ENTRANCE DRIVE
L-2	LANDSCAPING PLAN AREA 'B' - PARKING LOT 1
L-3	LANDSCAPING PLAN AREA 'C' - PARKING LOT 2 & 3
L-4	LANDSCAPING PLAN AREA 'D' - PARKING LOT 4
L-5	LANDSCAPING PLAN AREA 'E' & 'F' - BUILDING 1 & 2
L-6	LANDSCAPING PLAN AREA 'G' - BUILDING 3
L-7	LANDSCAPING PLAN AREA 'H' - BUILDING 4
L-8	LANDSCAPING PLAN AREA 'I' - SOUTH WATERFRONT
L-9	LANDSCAPING PLAN AREA 'J' & 'K' - CENTRAL WATERFRONT
L-10	LANDSCAPING PLAN AREA 'L' - NORTH WATERFRONT
L-11	LANDSCAPING PLAN AREA 'M' - NORTH WATERFRONT 2



FRONT ENTRANCE



DIG SAFELY  
NEW YORK  
www.digsafeny.com  
Dig Safely and Dig Smarter, New York  
are used under license from Dig Safe  
System, Inc.

- Call Before You Dig
- Mark the Required Ties
- Confirm Utility Response
- Respect the Marker
- Dig With Care

1-800-982-7962  
IT'S THE LAW!

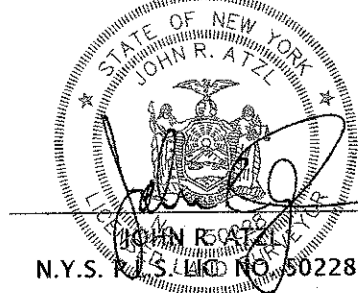
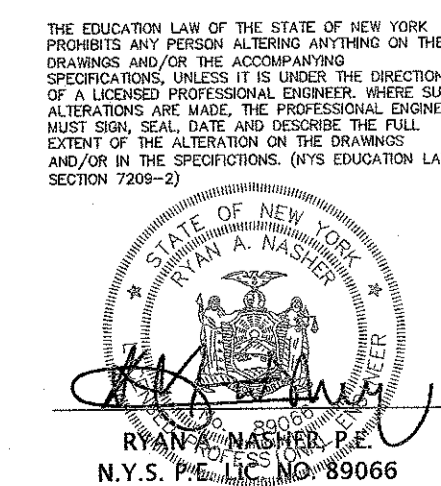

REVISION	DATE	DESCRIPTION
 <b>ATZL, NASHER &amp; ZIGLER P.C.</b> ENGINEERS-SURVEYORS-PLANNERS 232 North Main Street New City, New York 10956 Tel: (845) 634-4894 Fax: (845) 634-5543 E-mail: info@anzny.com Web: www.anzny.com		
<b>DANIEL SHERMAN</b> LANDSCAPE ARCHITECT 4 BROADWAY - SUITE 9 VALHALLA, N.Y. 10595  PHONE: (914) 824-0999 FAX: (914) 824-0251		
PROJECT: <b>EAGLE BAY</b>		
TITLE: <b>TOWN OF STONY POINT ROCKLAND COUNTY, NEW YORK</b>		
TITLE: <b>LANDSCAPING PLAN DIRECTORY</b>		
DRAWN BY: VC	CHECKED BY: DMZ	
DATE: JANUARY 28, 2021	SCALE: 1 IN. = 60 FT.	
PROJECT NO: <b>1407</b>	DRAWING NO: <b>L-0</b>	

**PLANTING SPECIFICATIONS:**

**GENERAL:** All plants, trees, and shrubs shall meet the specifications for "plant material" as per the American Standard for Nursery Stock. The landscape architect reserves the right to inspect all plants prior to shipping and installation. There are to be no substitutions of the plants without the consent of the landscape architect.

**PLANTING:** All plants shall be planted in pits two times the diameter of the root ball or container. Plant height should be placed at or slightly above previous grade. Pull back burlap from top of ball and cut wire on tree basket. Ensure that the burlap is not exposed above grade because of water loss. Staking and guying shall be used only when necessary. When the method is used, care should be taken to protect the tree bark and wires should be removed as soon as possible.

**MULCHING:** All planting beds (EXCEPT GROUNDCOVER) shall be mulched with three inches of shredded bark to conserve water and keep roots covered during initial growth stage. Do not place mulch heavily around crown of plants.

**WINTER CARE:** All trees and shrubs shall be sprayed with an anti-desiccant the first November after planting.

**WATERING:** All plants shall be watered by the contractor during the initial growth stage. Trees shall be heavily watered several times during the first month after planting and then regularly for the next two summers.

**PLANT GUARANTEE:** Contractor shall guarantee all newly installed plants for one-year provided that they are given proper watering/care and contractor is notified of unhealthy stressed plants immediately.

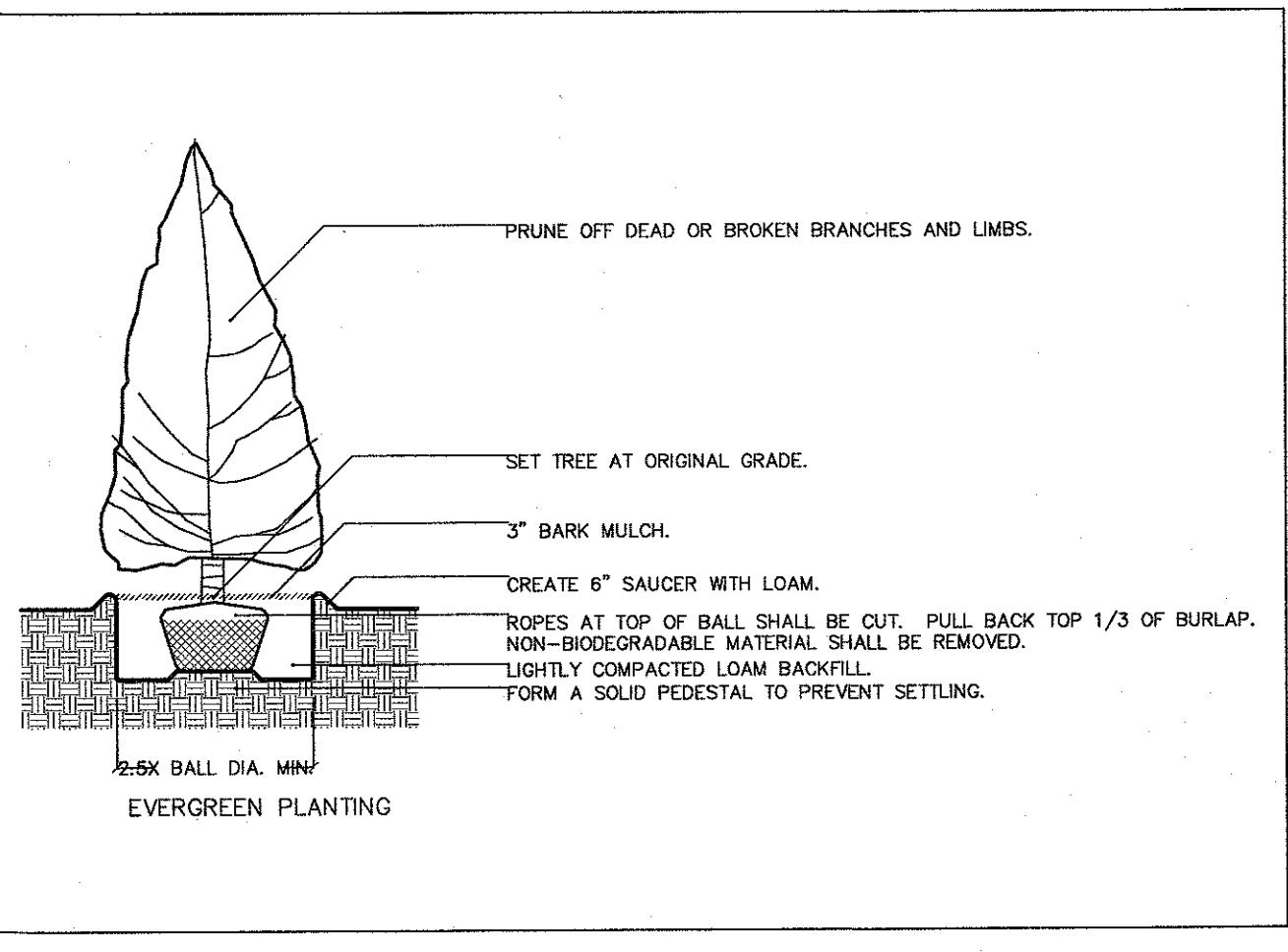
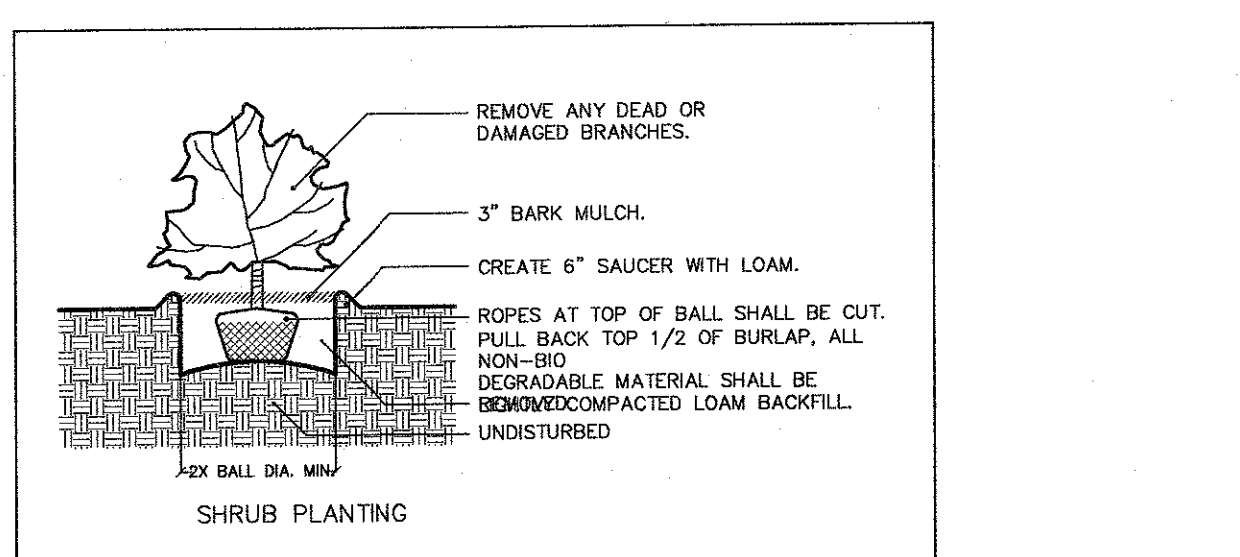
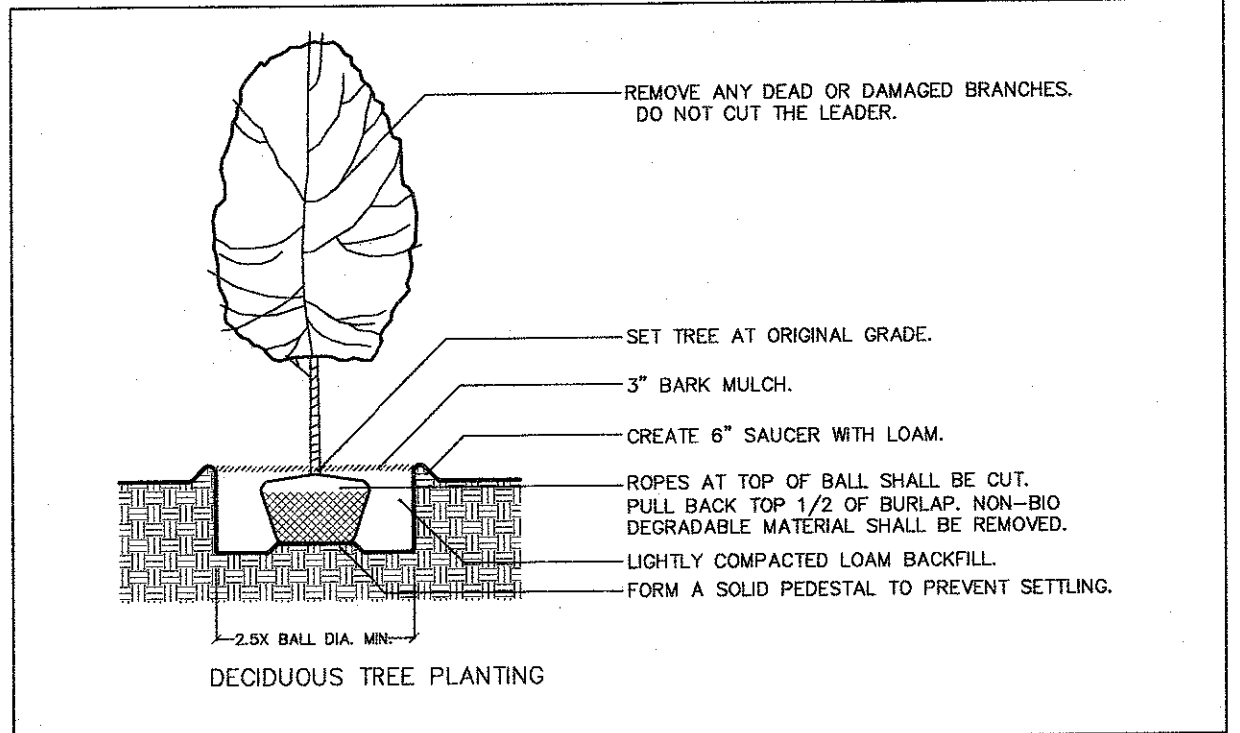

**RIP RAP WATERFRONT PLANTING**

**Area for Rip Rap planting:** The area of planting shall be from the average high tide level to the top of the Rip Rap wall embankment. The full length of the water front Rip Rap sea wall shall be vegetated with the rooted plug plantings. The length of the water front Rip Rap sea wall is 1,462 linear feet. The area from the level of mean high tide (elevation +3') to the top of the sea wall (elevation +8') providing an exposed rip-rap area of 5' x 1,462 linear feet = 7,310 face feet of area for vegetative planting.

Spacing the plantings at 1 plant per 4 face feet = 1,800 plants.

**Plant Material for the Rip Rap sea wall -** Plant material shall be live herbaceous, well rooted stock obtained from commercial sources in bare-root form. The root stock shall be full and at least 6" in length.

*Deschampsia cespitosa* - Tufted Hairgrass: 60% of Rip Rap area @ 1 per 4 face foot = 1,080 plants.

*Iris versicolor* - Blue Flag Iris: 10% of Rip Rap area @ 1 per 4 face foot = 180 plants.

*Juncus effusus* - Soft Rush: 20% of Rip Rap area @ 1 per 4 face foot = 360 plants.

*Rudbeckia hirta* - Black-eyed Susan: 10% of Rip Rap area @ 1 per 4 face foot = 180 plants.

**Planting and Stabilized Bare Root plantings:** The plantings shall be rolled with soil and organic compost soil material with 8" x 8" sections of decomposable, jute erosion blanket material and fitted into the voids in the rip rap shore embankment. Where the rock voids are large the rolled plantings shall be stabilized with cobble rock and gravel.

The rooted plug plantings shall be planted in randomly placed patches with 15-20 plants in each patched area.

Key	Scientific Name	Common Name	Size	
<b>Trees</b>				
T1	<i>Acer rubrum</i>	Red Maple	2.5'-3" cal.	Wrap trunks first winter for sun and wind damage
T2	<i>Acer saccharum</i>	Sugar Maple	2.5'-3" cal.	Wrap trunks first winter for sun and wind damage
T3	<i>Amelanchier canadensis</i>	Shadbowl Serviceberry	8-10' ht.	Wrap trunks first winter for sun and wind damage
T4	<i>Crataegus viridis 'Winter King'</i>	Winter King Hawthorn	2.5'-3" cal.	Wrap trunks first winter for sun and wind damage
T5	<i>Cornus alternifolia</i>	Alternate Leaf Dogwood	8-10' ht.	Wrap trunks first winter for sun and wind damage
T6	<i>Gleditsia triacanthos</i>	Thornless Common Honeylocust	2.5'-3" cal.	Wrap trunks first winter for sun and wind damage
T7	<i>Ilex opaca</i>	American Holly	3-4' ht.	Spray first winter with anti-desiccant
T8	<i>Ilex opaca</i>	American Holly	8-10' ht.	Spray first winter with anti-desiccant
T9	<i>Juniperus virginiana</i>	Eastern Red Cedar	8-10' ht.	Spray first winter with anti-desiccant
T10	<i>Nyssa sylvatica</i>	Black Tupelo	2.5'-3" cal.	Wrap trunks first winter for sun and wind damage
T11	<i>Pinus rigida</i>	Pin	8-10' ht.	Wrap trunks first winter for sun and wind damage
T12	<i>Platanus occidentalis</i>	American Sycamore	2.5'-3" cal.	Wrap trunks first winter for sun and wind damage
T13	<i>Quercus bicolor</i>	Swamp White Oak	2.5'-3" cal.	Wrap trunks first winter for sun and wind damage
T14	<i>Quercus palustris</i>	Pin Oak	2.5'-3" cal.	Wrap trunks first winter for sun and wind damage
<b>Shrubs</b>				
S1	<i>Aronia melanocarpa</i>	Black Chokeberry	5 gal.	Prune to maintain at 3' to 4' height.
S2	<i>Cephalanthus occidentalis</i>	Button Bush	5 gal.	Prune to maintain at 3' to 4' height.
S3	<i>Cornus sericea</i>	Red Twig Dogwood	5 gal.	Prune to maintain at 3' to 4' height.
S4	<i>Diervilla lonicera</i>	Northern Bush Honeysuckle	5 gal.	Prune to maintain at 3' to 4' height.
S5	<i>Hydrangea arborescens 'Annabelle'</i>	Annabelle Hydrangea	5 gal.	Dead Head after flowering
S6	<i>Ilex crenata 'Chesapeake'</i>	Chesapeake Holly	4" ht.	Maintain as neat, rounded hedge, spray in winter with anti-desiccant
S7	<i>Ilex glabra</i>	Boxwood	24"-36" ht.	Maintain as neat, rounded hedge, spray in winter with anti-desiccant
S8	<i>Ilex verticillata</i>	Winterberry	3-4" ht.	Prune to maintain at 4' to 5' height.
S9	<i>Itea virginica</i>	Virginia Sweetspire	5 gal.	Prune to maintain at 3' to 4' height.
S10	<i>Juniperus horizontalis 'wiltoni'</i>	Wilton Carpet Juniper	3 gal.	Maintain from growing out into paths or lawns.
S10a	<i>Juniperus chinensis 'sargentii'</i>	Sargent Juniper	3 gal.	Prune to maintain at 4' to 5' height.
S11	<i>Myrica pennsylvanica</i>	Bayberry	5 gal.	Prune to maintain at 4' to 5' height.
S12	<i>Physocarpus opulifolius 'Diabolo'</i>	Diabolo	7 gal.	Prune to maintain at 4' to 5' height.
S13	<i>Rudbeckia hirta</i>	Black-eyed Susan	5 gal.	Prune to maintain at 3' to 4' height.
S14	<i>Rhododendron spp. 'parcilymenoides'</i>	Pinxter Azalea	3-4" ht.	Prune to maintain at 3' to 4' height.
S15	<i>Rosa carolina</i>	Pasture Rose	5 gal.	Prune to maintain at 3' to 4' height.
S16	<i>Viburnum acerifolium</i>	Mapleleaf Viburnum	7 gal.	Prune to maintain at 4' to 5' height.
S17	<i>Viburnum dentatum</i>	Arrowwood Viburnum	7 gal.	Prune to maintain at 5' to 6' height.
S18	<i>Viburnum lentago</i>	Nannyberry	5 gal.	Prune to maintain at 5' to 6' height.
S19	<i>Viburnum plicatum tom. 'Shasta'</i>	Double Viburnum 'Shasta'	10 gal.	Prune to maintain at 5' to 6' height.
<b>Perennials</b>				
P1	<i>Aster divaricatus</i>	White Heather Asters	1 gal.	Keep free of weeds, dead head after flowering
P2	<i>Astilbe spp.</i>	Astilbe	1 gal.	Keep free of weeds, dead head after flowering
P3	<i>Carex obnema</i>	Ivory Sedge	1 gal.	Keep free of weeds
P4	<i>Carex platyphylla</i>	Broad-Leaf Sedge	1 gal.	Keep free of weeds
P5	<i>Coreopsis lanceolata</i>	Lanceleaf Coreopsis	1 gal.	Keep free of weeds, dead head after flowering
P6	<i>Echinacea</i>	Cone Flower	1 gal.	Keep free of weeds, dead head after flowering
P6a	<i>Eupatorium purpureum</i>	Purple Joe-Pye Weed	1 gal.	Keep free of weeds, dead head after flowering
P7	<i>Geranium maculatum</i>	Wild Geranium	1 gal.	Keep free of weeds
P8	<i>Huechera americana</i>	Coral Bells	1 gal.	Keep free of weeds, dead head after flowering
P9	<i>Iris versicolor</i>	Blue Flag Iris	1 gal.	Keep free of weeds, dead head after flowering
P10	<i>Liatris spicata</i>	Blazing Star	1 gal.	Keep free of weeds, dead head after flowering
P11	<i>Monarda didyma</i>	Scarlet Salibalm, Osage Tea	1 gal.	Keep free of weeds, dead head after flowering
P12	<i>Oenothera fruticosa</i>	Sundrops	1 gal.	Keep free of weeds, mow clean in April
P13	<i>Rudbeckia hirta</i>	Black Eye Susans	1 gal.	Keep free of weeds, dead head after flowering
P14	<i>Urtica paniculata</i>	Sea Oats	1 gal.	Keep free of weeds, mow clean in April
<b>Ground Covers</b>				
GC1	<i>Arcostaphylos uvaursi</i>	Bear Berry	4" pots	Keep free of weeds
GC2	<i>Liriope spicata</i>	Liriope	1 gal.	Keep free of weeds, cut foliage off in March / April
GC3	<i>Pachysandra terminalis</i>	Pachysandra	1 gal.	Keep free of weeds
GC4	<i>Vinca minor</i>	Myrtle	1 gal.	Keep free of weeds
<b>Ferns</b>				
F1	<i>Oncoclea sensibilis</i>	Sensitive Fern	1 gal.	Keep free of weeds
<b>Rip Rap Plantings</b>				
RR1	<i>Deschampsia cespitosa</i>	Tufted Hairgrass	plug	Keep free of weeds
RR2	<i>Iris versicolor</i>	Blue Flag Iris	plug	Keep free of weeds
RR3	<i>Juncus effusus</i>	Soft Rush	plug	Keep free of weeds
RR4	<i>Rudbeckia hirta</i>	Black-eyed Susan	plug	Keep free of weeds

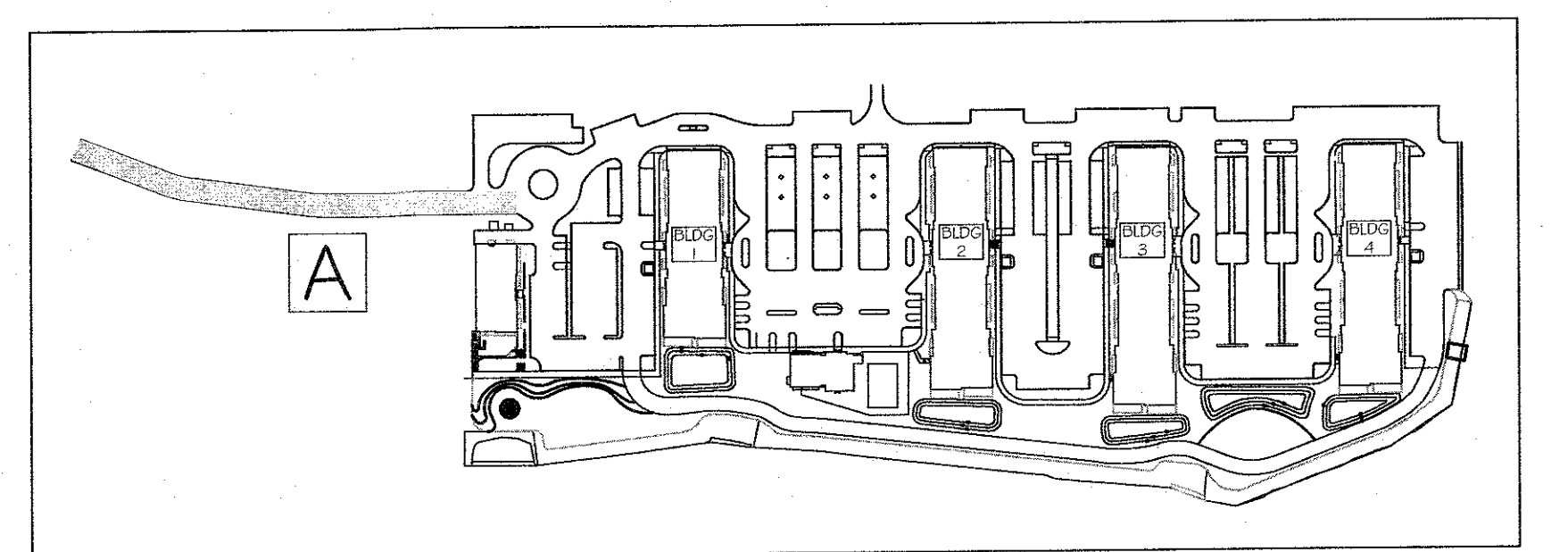

Key	Scientific Name	Common Name	Size	Quantity
T1	<i>Acer rubrum</i>	Red Maple	2.5'-3" cal.	34

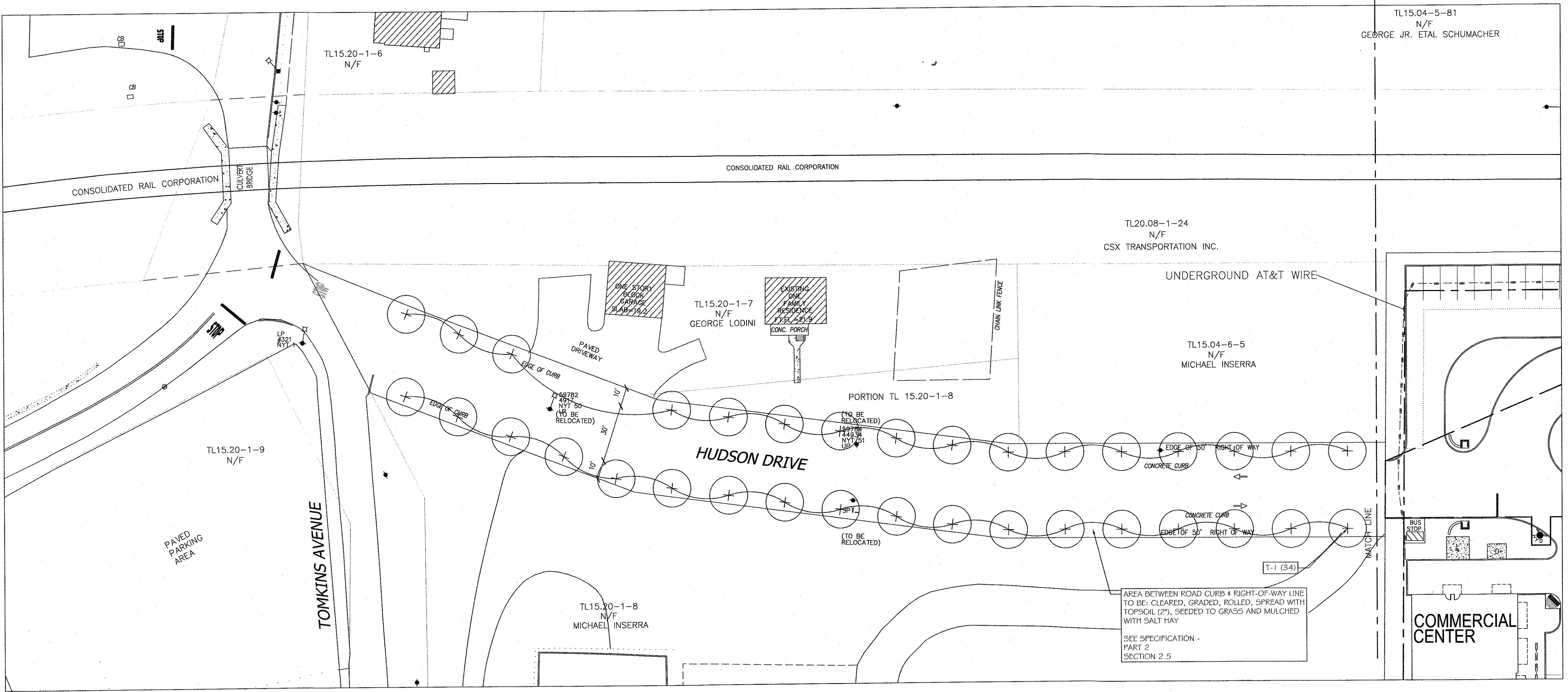

PLAN - ENTRANCE DRIVE - AREA 'A'

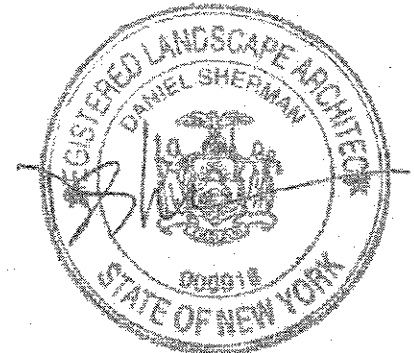

DANIEL SHERMAN  
 LANDSCAPE ARCHITECT  
 4 BROADWAY SUITE 9  
 VALHALLA, NY 10595  
 PHONE: (914) 824 - 0999  
 FAX: (914) 824-0251

PROJECT:  
**EAGLE BAY**

TOWN OF STONY POINT  
 ROCKLAND COUNTY, NEW YORK

TITLE:  
**LANDSCAPING PLAN  
 AREA 'A' - ENTRANCE DRIVE**

DRAWN BY: AL	CHECKED BY: DMS
DATE: JANUARY 28, 2021	SCALE: 1 IN. = 30 FT.
PROJECT NO: 1407	DRAWING NO: L-1



Landscape Sheet L-3				
Key	Scientific Name	Common Name	Size	Quantity
<b>Trees</b>				
T4	<i>Crataegus vinctus</i> 'Winter King'	Winter King Hawthorn	2.5'-3" cal.	17
T6	<i>Gleditsia triacanthos</i>	Thornless Common Honeylocust	2.5'-3" cal.	8
T8	<i>Ilex opaca</i>	American Holly	8'-10" ht.	1
T10	<i>Nyssa sylvatica</i>	Black Tupelo	2.5'-3" cal.	16
T11	<i>Pinus rigida</i>	Pitch Pine	8'-10" ht.	4
T14	<i>Quercus palustris</i>	Pin Oak	2.5'-3" cal.	9
<b>Shrubs</b>				
S4	<i>Diervilla lonicera</i>	Northern Bush Honeysuckle	5 gal.	86
S6	<i>Ilex crenata</i> 'Chesapeake'	Chesapeake Holly	4 ht.	17
S7	<i>Ilex glabra</i>	inkberry	24"-36" ht.	66
S12	<i>Physocarpus opulifolius</i> 'Diabolo'	Ninebark	7 gal.	15
S15	<i>Rosa carolina</i>	Pasture Rose	5 gal.	14
<b>Perennials</b>				
P5	<i>Coreopsis lanceolata</i>	Lanceleaf Coreopsis	1 gal.	260
P12	<i>Oenothera fruticosa</i>	Sundrops	1 gal.	40
P13	<i>Rudbeckia hirta</i>	Black Eye Susans	1 gal.	144
<b>Ground Covers</b>				
GC2	<i>Liriope spicata</i>	Liriope	1 gal.	300
GC3	<i>Pachysandra terminalis</i>	Pachysandra	flats	64
GC4	<i>Vinca minor</i>	Myrtle	1 gal.	125
<b>Ferns</b>				
F1	<i>Oncoclea sensibilis</i>	Sensitive Fern	1 gal.	70

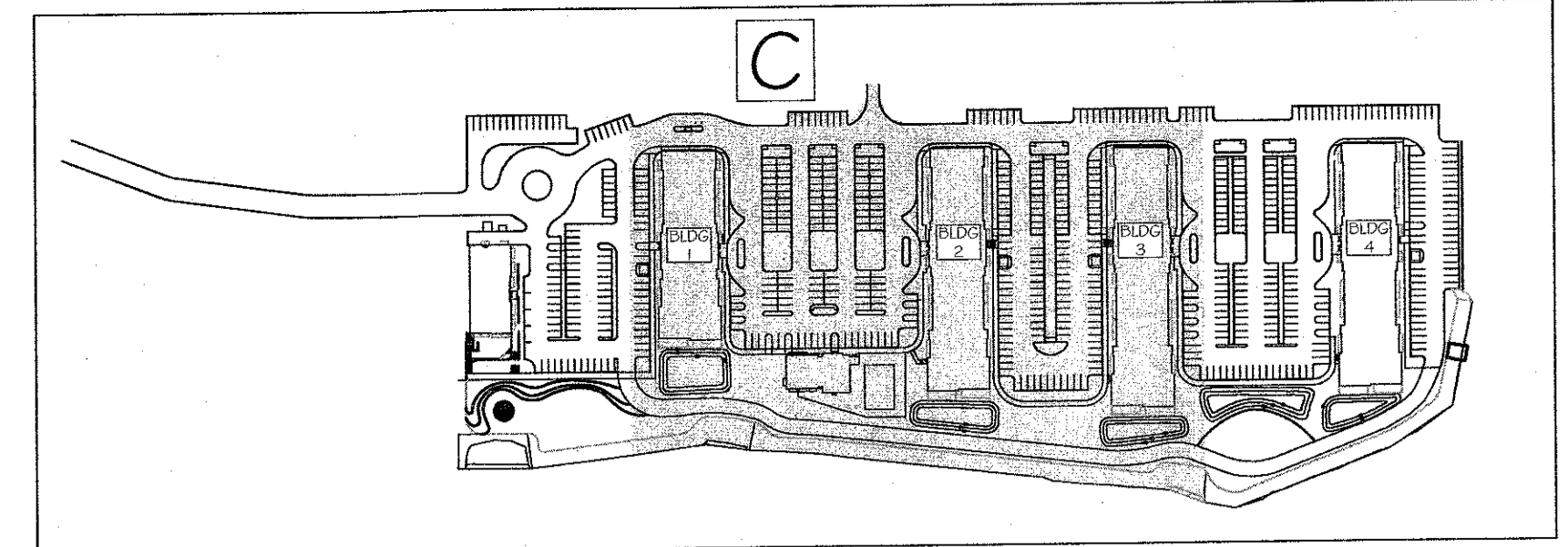

KEY PLAN  
NOT TO SCALE

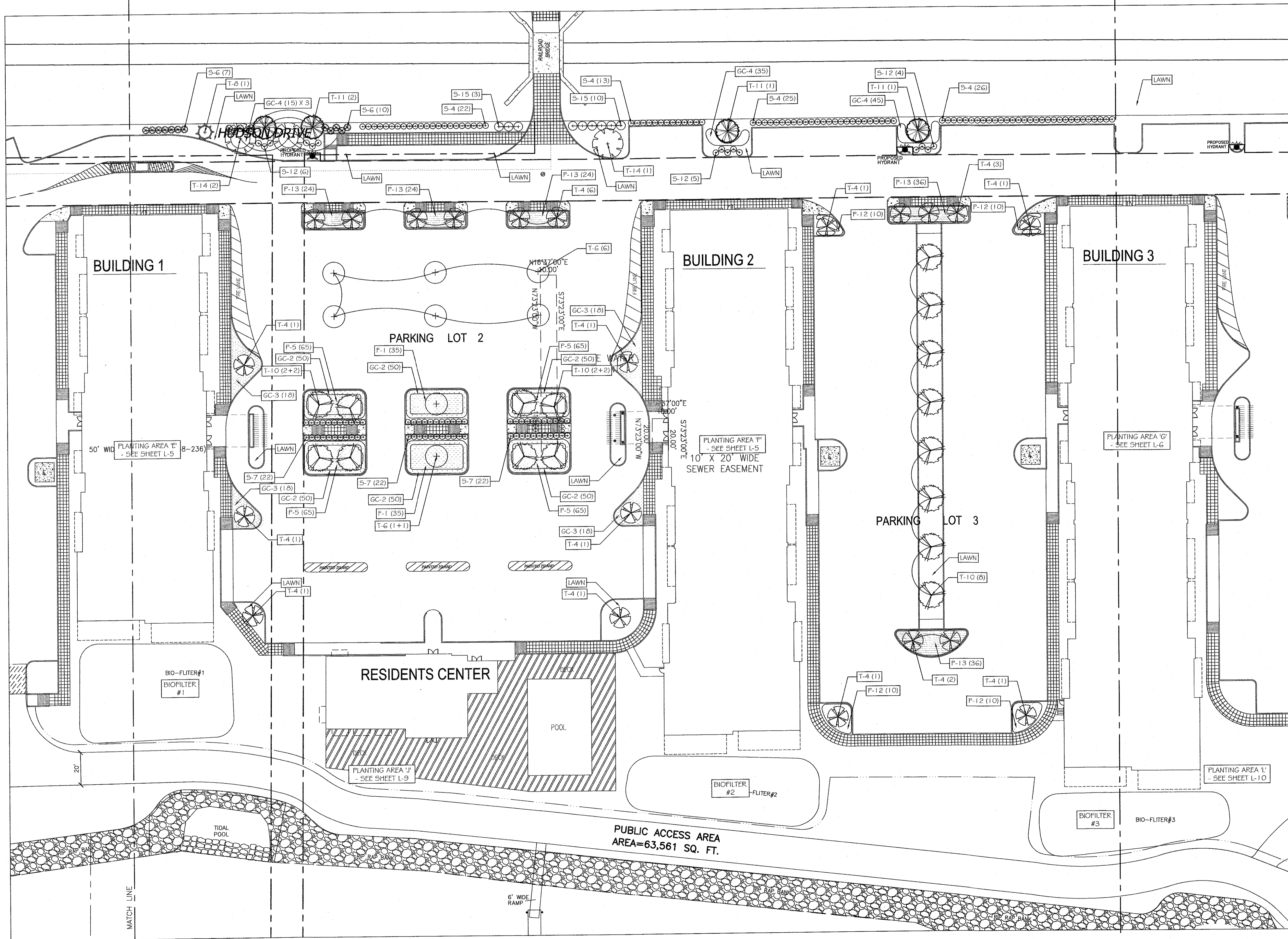

PLAN - PARKING LOT 2 & 3 - AREA 'C'

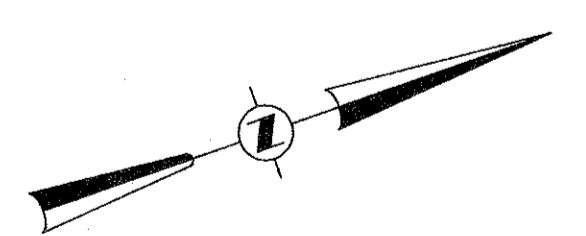

DANIEL SHERMAN  
LANDSCAPE ARCHITECT  
4 BROADWAY - SUITE 9  
VALHALLA, NY 10595  
PHONE: (914) 824 - 0999  
FAX: (914) 824-0251

PROJECT:  
**EAGLE BAY**

TOWN OF STONY POINT  
ROCKLAND COUNTY, NEW YORK

TITLE:  
**LANDSCAPING PLAN  
AREA 'C' - PARKING LOT 2 & 3**

DRAWN BY: AL	CHECKED BY: DMS
DATE: JANUARY 28, 2021	SCALE: 1 IN. = 30 FT.
PROJECT NO:	DRAWING NO:

1407 L-3

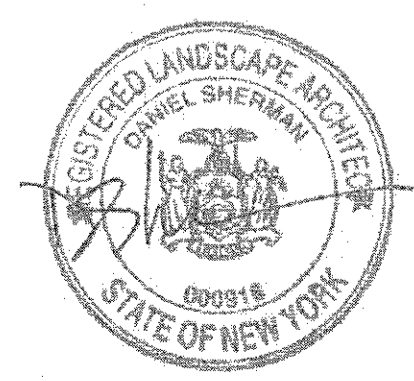



Landscape Sheet L-5 - Building 2				
Key	Scientific Name	Common Name	Size	Quantity
<b>Trees</b>				
T8	<i>Ilex opaca</i>	American Holly	8'-10' ht.	3
<b>Shrubs</b>				
S3	<i>Cornus sericea</i>	Red Twig Dogwood	5 gal.	64
S5	<i>Hydrangea arborescens 'Annabelle'</i>	Annabelle Hydrangea	5 gal.	12
S6	<i>Ilex crenata 'Chesapeake'</i>	Chesapeake Holly	4' ht.	34
S7	<i>Ilex glabra</i>	Inkberry	24"-36" ht.	12
S9	<i>Itea virginica</i>	Virginia Sweetspire	5 gal.	18
S17	<i>Viburnum dentatum</i>	Arrowwood Viburnum	7 gal.	16
<b>Perennials</b>				
P6	<i>Echinacea</i>	Cone Flower	1 gal.	72
<b>Ground Covers</b>				
GC2	<i>Liriope spicata</i>	Liriope	1 gal.	132

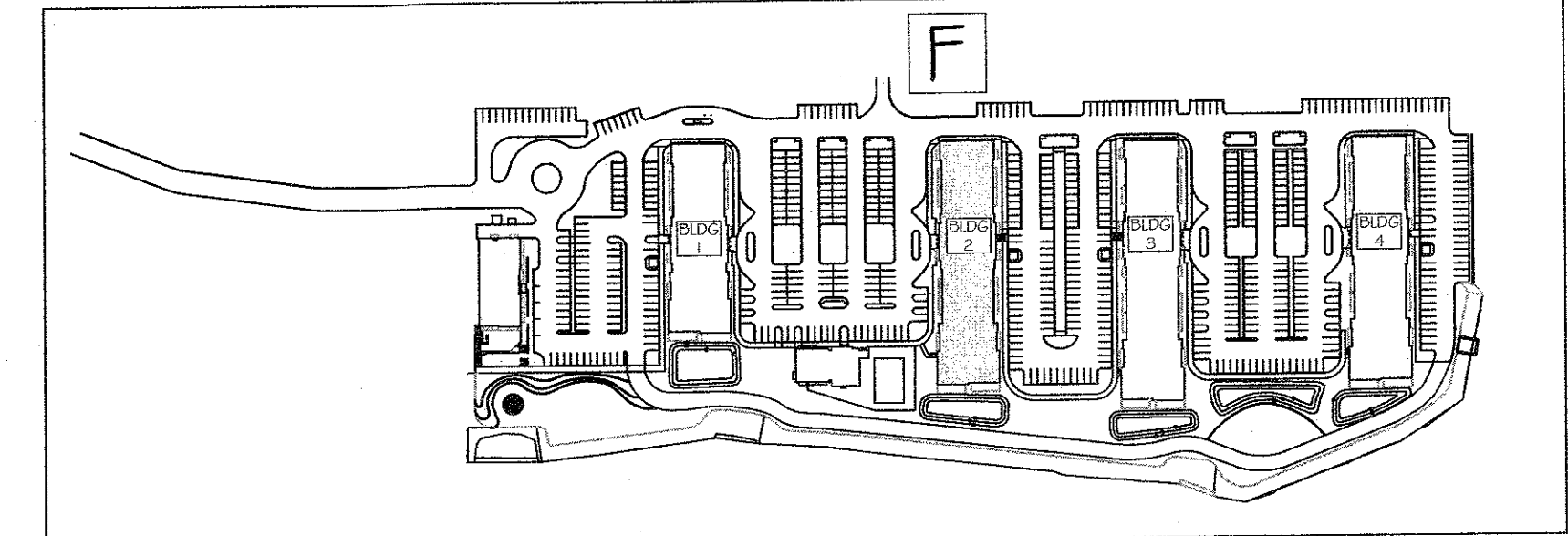

KEY PLAN  
NOT TO SCALE

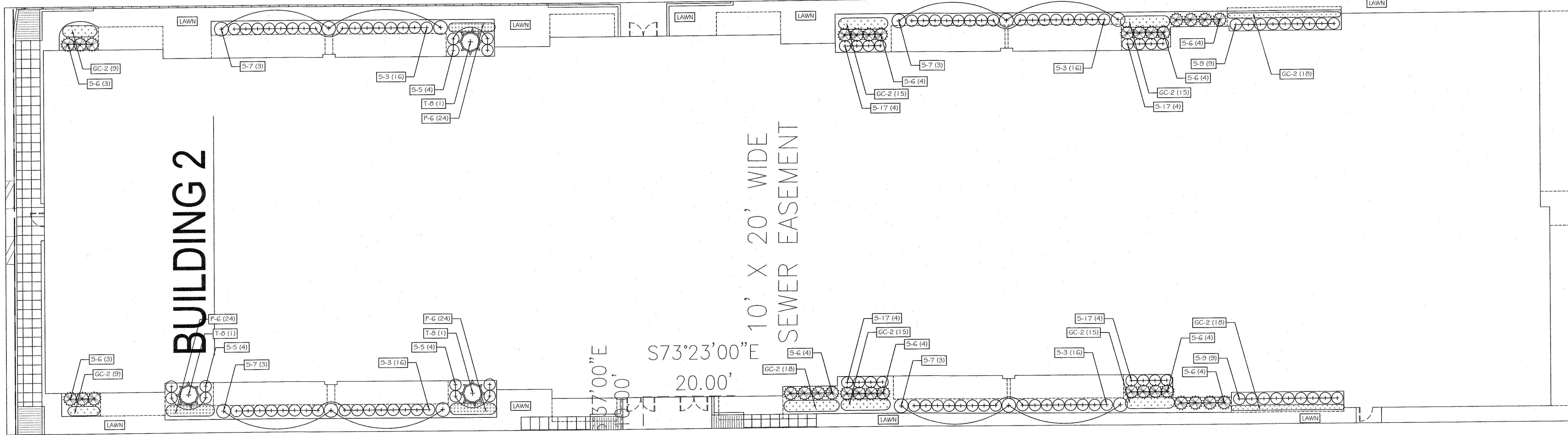

PLAN - BUILDING 2 - AREA F

Landscape Sheet L-5 - Building 1				
Key	Scientific Name	Common Name	Size	Quantity
<b>Trees</b>				
T8	<i>Ilex opaca</i>	American Holly	8'-10' ht.	4
<b>Shrubs</b>				
S3	<i>Cornus sericea</i>	Red Twig Dogwood	5 gal.	32
S5	<i>Hydrangea arborescens 'Annabelle'</i>	Annabelle Hydrangea	5 gal.	16
S6	<i>Ilex crenata 'Chesapeake'</i>	Chesapeake Holly	4' ht.	22
S7	<i>Ilex glabra</i>	Inkberry	24"-36" ht.	6
S9	<i>Itea virginica</i>	Virginia Sweetspire	5 gal.	18
<b>Perennials</b>				
P6	<i>Echinacea</i>	Cone Flower	1 gal.	96
<b>Ground Covers</b>				
GC2	<i>Liriope spicata</i>	Liriope	1 gal.	90

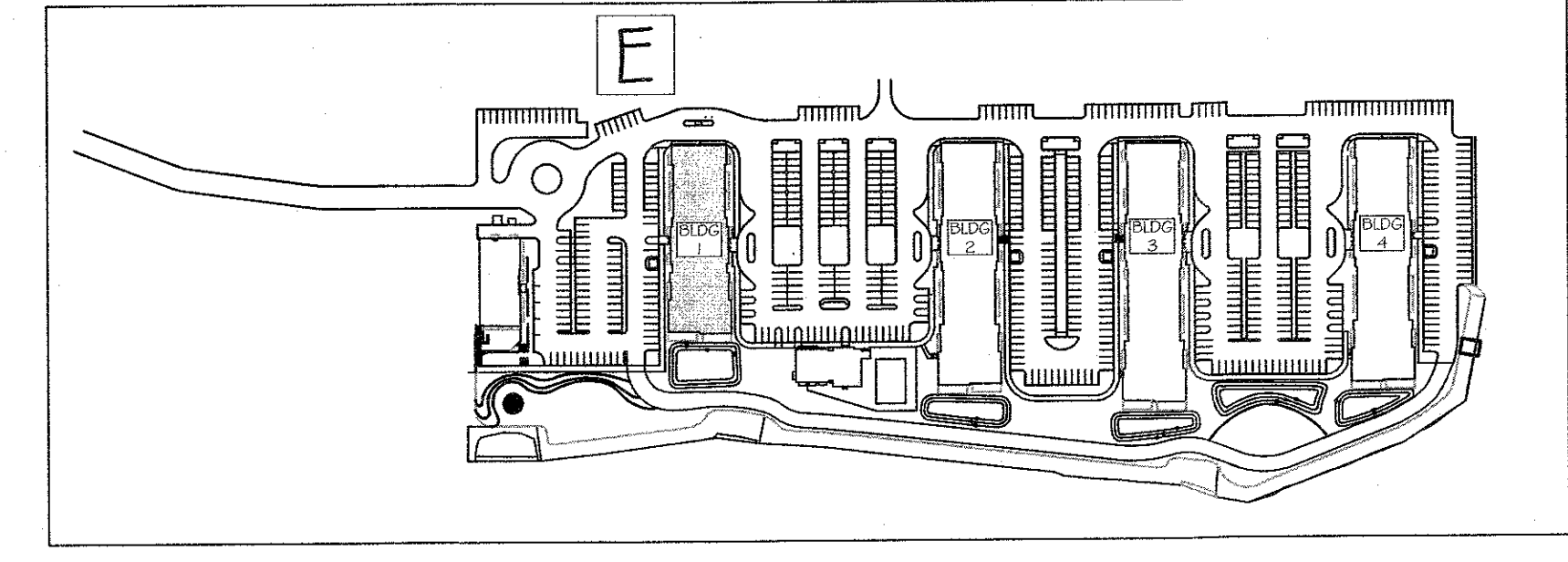

KEY PLAN  
NOT TO SCALE

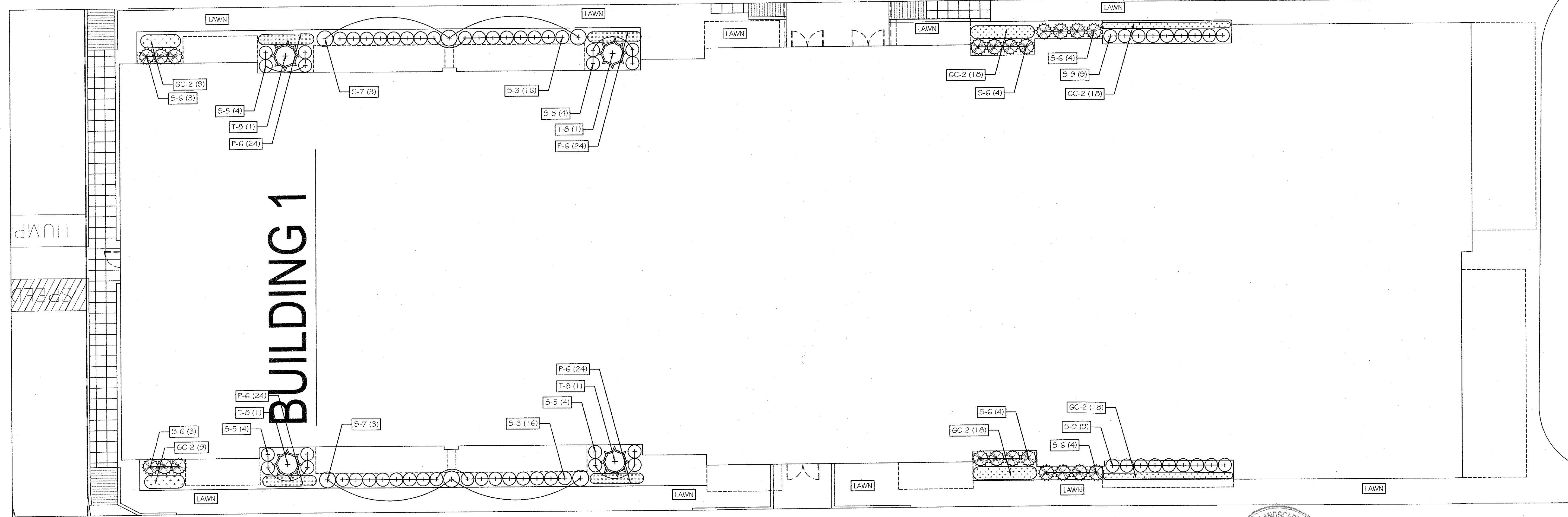

PLAN - BUILDING 1 - AREA E

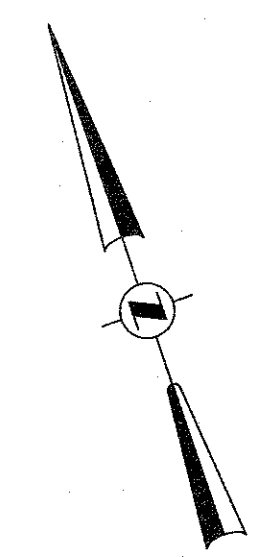

DANIEL SHERMAN  
LANDSCAPE ARCHITECT  
4 BROADWAY - SUITE 9  
VALHALLA, NY 10595  
PHONE: (914) 824 - 0999  
FAX: (914) 824-0251

PROJECT:  
**EAGLE BAY**

TOWN OF STONY POINT  
ROCKLAND COUNTY, NEW YORK

TITLE:  
**LANDSCAPING PLAN  
AREA 'E' & 'F' - BUILDING 1 & 2**

DRAWN BY: AL	CHECKED BY: DMS
DATE: JANUARY 28, 2021	SCALE: 1 IN. = 10 FT.
PROJECT NO:	DRAWING NO:
<b>1407</b>	<b>L-5</b>

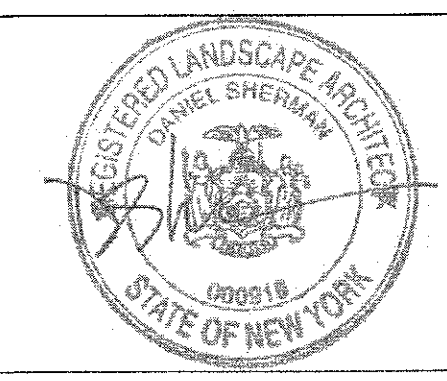

Landscape Sheet L-5 - Building 3				
Key	Scientific Name	Common Name	Size	Quantity
<b>Trees</b>				
T8	<i>Ilex opaca</i>	American Holly	8'-10' ht.	5
<b>Shrubs</b>				
S3	<i>Cornus sericea</i>	Red Twig Dogwood	5 gal.	32
S5	<i>Hydrangea arborescens 'Annabelle'</i>	Annabelle Hydrangea	5 gal.	8
S6	<i>Ilex crenata 'Chesapeake'</i>	Chesapeake Holly	2' ht.	50
S7	<i>Ilex glabra</i>	Hickberry	24"-36" ht.	6
S9	<i>Itea virginica</i>	Virginia Sweetspire	5 gal.	18
S10	<i>Juniperus horizontalis 'Wilton'</i>	Wilton Carpet Juniper	3 gal.	18
S12	<i>Physocarpus opulifolius 'Diabolo'</i>	Ninebark	7 gal.	3
S13	<i>Potentilla fruticosa</i>	Bush Cinquifloie	5 gal.	8
S17	<i>Viburnum dentatum</i>	Arrowwood Viburnum	7 gal.	24
S19	<i>Viburnum plicatum tom. 'Shasta'</i>	Double Viburnum 'Shasta'	10 gal.	8

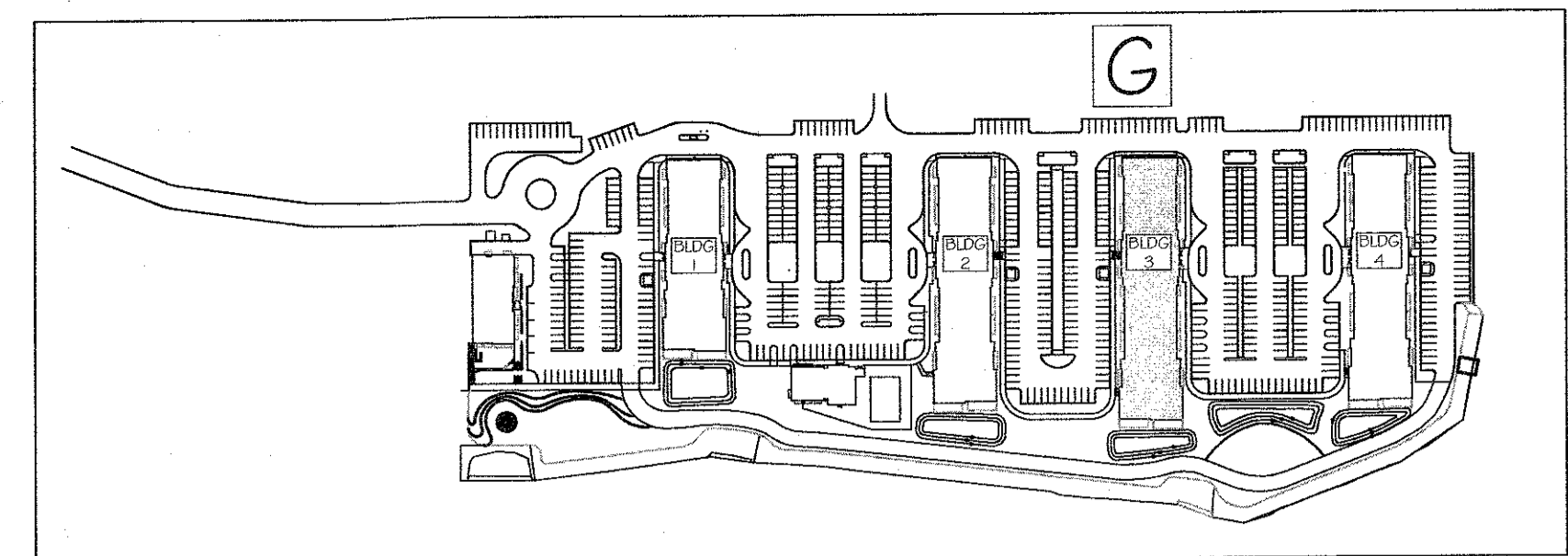

KEY PLAN  
NOT TO SCALE

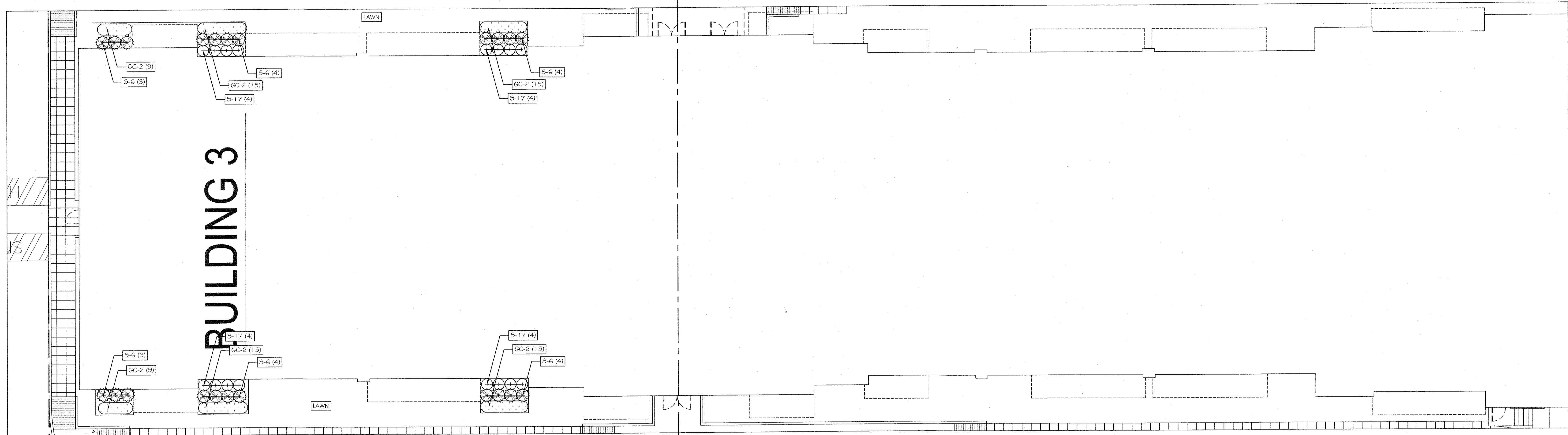

PLAN - BUILDING 3 - AREA 'G'

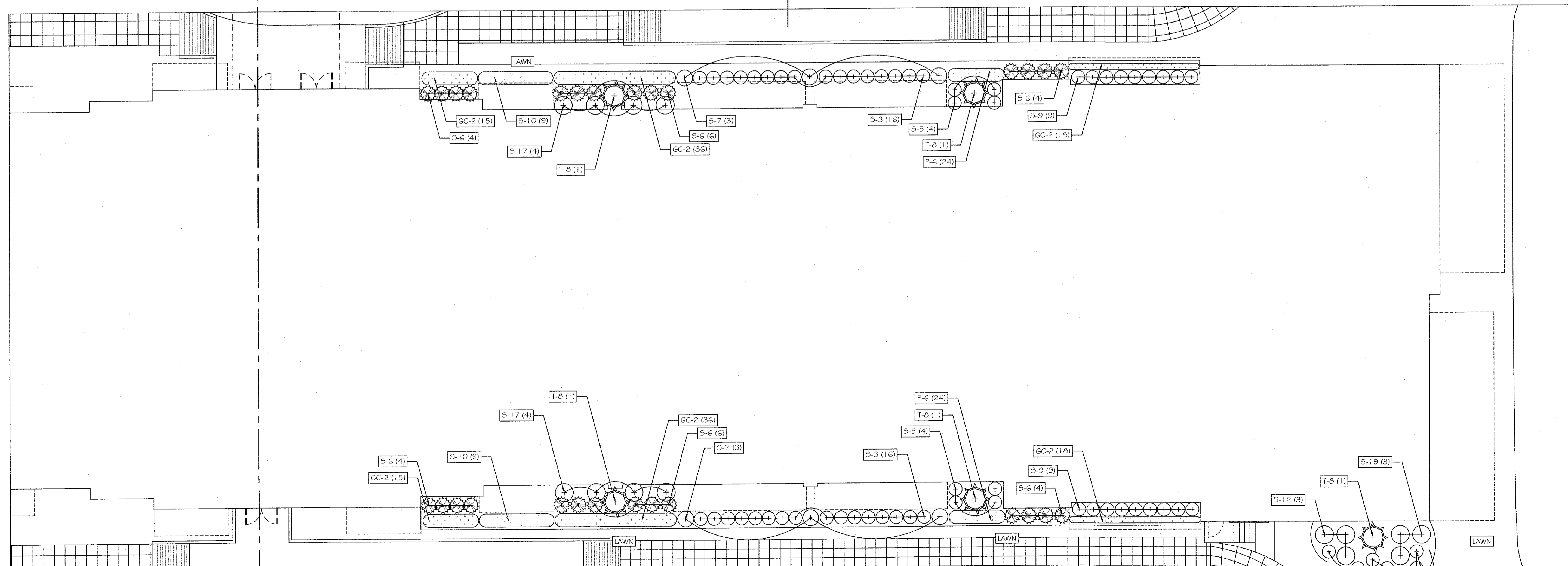

PLAN - BUILDING 3 - AREA 'G'

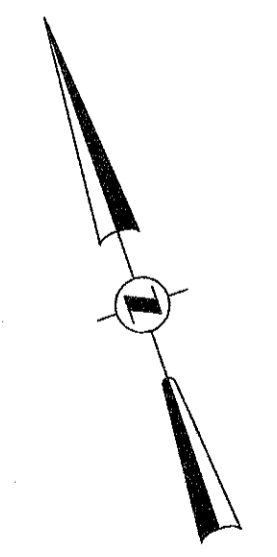

DANIEL SHERMAN  
LANDSCAPE ARCHITECT  
4 BROADWAY - SUITE 9  
VALHALLA, NY 10595  
PHONE: (914) 824 - 0999  
FAX: (914) 824-0251

PROJECT: EAGLE BAY

TOWN OF STONY POINT  
ROCKLAND COUNTY, NEW YORK

TITLE: LANDSCAPING PLAN  
AREA 'G' - BUILDING 3

DRAWN BY: AL  
DATE: JANUARY 28, 2021  
PROJECT NO: 1407

CHECKED BY: DMS  
SCALE: 1 IN. = 10 FT.  
DRAWING NO: L-6

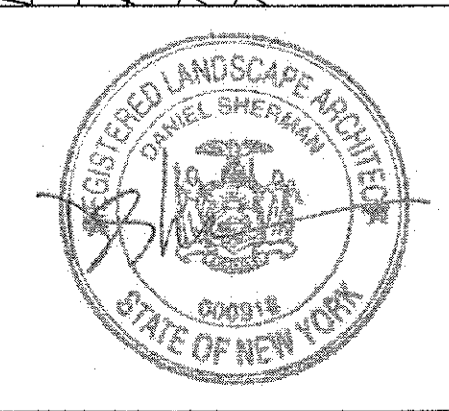

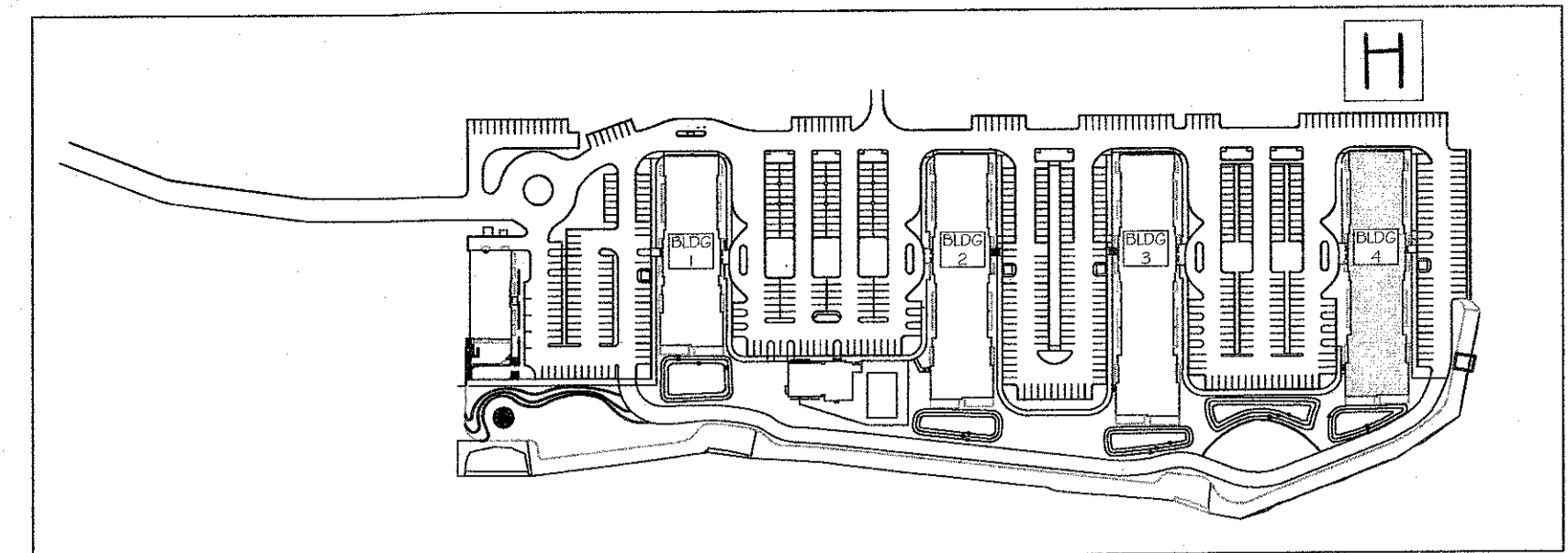

KEY PLAN  
NOT TO SCALE

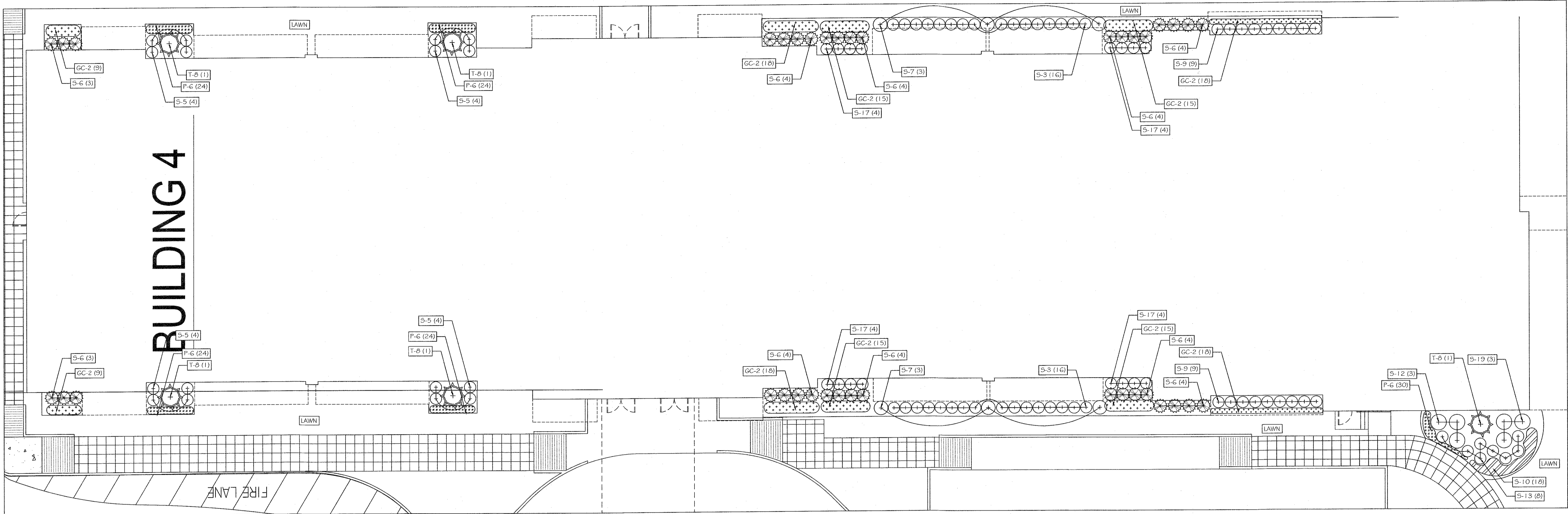

PLAN - BUILDING 4 - AREA 'H'

**Landscape Sheet L-7 - Building 4**

Key	Scientific Name	Common Name	Size	Quantity
<b>Trees</b>				
T8	<i>Ilex opaca</i>	American Holly	8'-10' ht.	5
<b>Shrubs</b>				
S3	<i>Cornus sericea</i>	Red Twig Dogwood	5 gal.	32
S5	<i>Hydrangea arborescens</i> 'Annabelle'	Annabelle Hydrangea	5 gal.	16
S6	<i>Ilex crenata</i> 'Chesapeake'	Chesapeake Holly	4' ht.	38
S7	<i>Ilex glabra</i>	Inkberry	24"-36" ht.	6
S9	<i>Itea virginica</i>	Virginia Sweetspire	5 gal.	18
S10	<i>Juniperus horizontalis</i> 'wiltonii'	Wilton Carpet Juniper	3 gal.	18
S12	<i>Physocarpus opulifolius</i> 'Diablo'	Ninebark	7 gal.	3
S13	<i>Potentilla fruticosa</i>	Bush Cinquifoliate	5 gal.	8
S17	<i>Viburnum dentatum</i>	Arrowwood Viburnum	7 gal.	16
S19	<i>Viburnum plicatum</i> tom. 'Shasta'	Double Viburnum 'Shasta'	10 gal.	3
<b>Perennials</b>				
P6	<i>Echinacea</i>	Cone Flower	1 gal.	128
<b>Ground Covers</b>				
GC2	<i>Liriope spicata</i>	Liriope	1 gal.	150

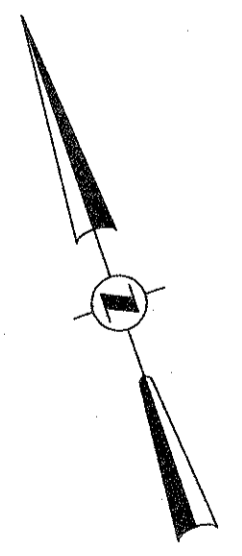

DANIEL SHERMAN  
LANDSCAPE ARCHITECT  
4 BROADWAY - SUITE 9  
VALHALLA, NY 10595  
PHONE: (914) 824 - 0999  
FAX: (914) 824-0251

PROJECT:	EAGLE BAY	
TITLE:	LANDSCAPING PLAN AREA 'H' - BUILDING 4	
DATE:	JANUARY 28, 2021	CHECKED BY: DMS
PROJECT NO:	1407	SCALE: 1 IN. = 10 FT.
		DRAWING NO: L-7

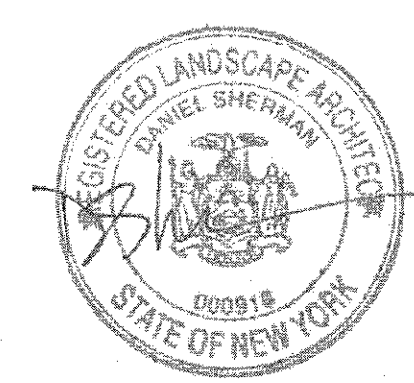



Landscape Sheet L-8				
Key	Scientific Name	Common Name	Size	Quantity
<b>Trees</b>				
T6	<i>Gleditsia triacanthos</i>	Thornless Common Honeylocust	2.5"-3" cal.	6
T7	<i>Ilex opaca</i>	American Holly	3'-4" ht.	1
T12	<i>Platanus occidentalis</i>	American Sycamore	2.5"-3" cal.	3
T13	<i>Quercus bicolor</i>	Swamp White Oak	2.5"-3" cal.	7
<b>Shrubs</b>				
S3	<i>Cornus sericea</i>	Red Twig Dogwood	5 gal.	9
S11	<i>Myrica pennsylvanica</i>	Bayberry	5 gal.	9
S13	<i>Potentilla fruticosa</i>	Bush Cinquifoliate	5 gal.	6
S15	<i>Rosa carolina</i>	Pasture Rose	5 gal.	17
<b>Perennials</b>				
P1	<i>Aster divaricatus</i>	White Heather Asters	1 gal.	70
P6	<i>Echinacea</i>	Cone Flower	1 gal.	24
P12	<i>Chenopodium frutescens</i>	Sundrops	1 gal.	18
P13	<i>Rudbeckia hirta</i>	Black Eye Susans	1 gal.	35
P14	<i>Uniola paniculata</i>	Sea Oats	1 gal.	150

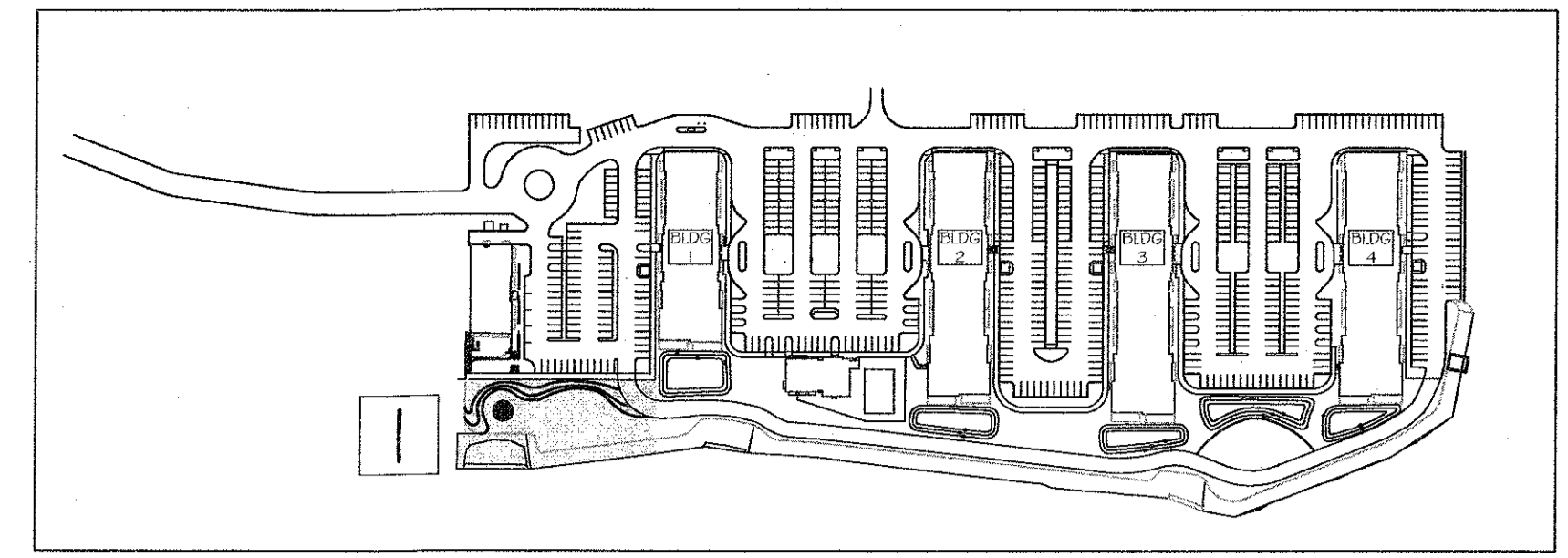

○ KEY PLAN  
○ NOT TO SCALE

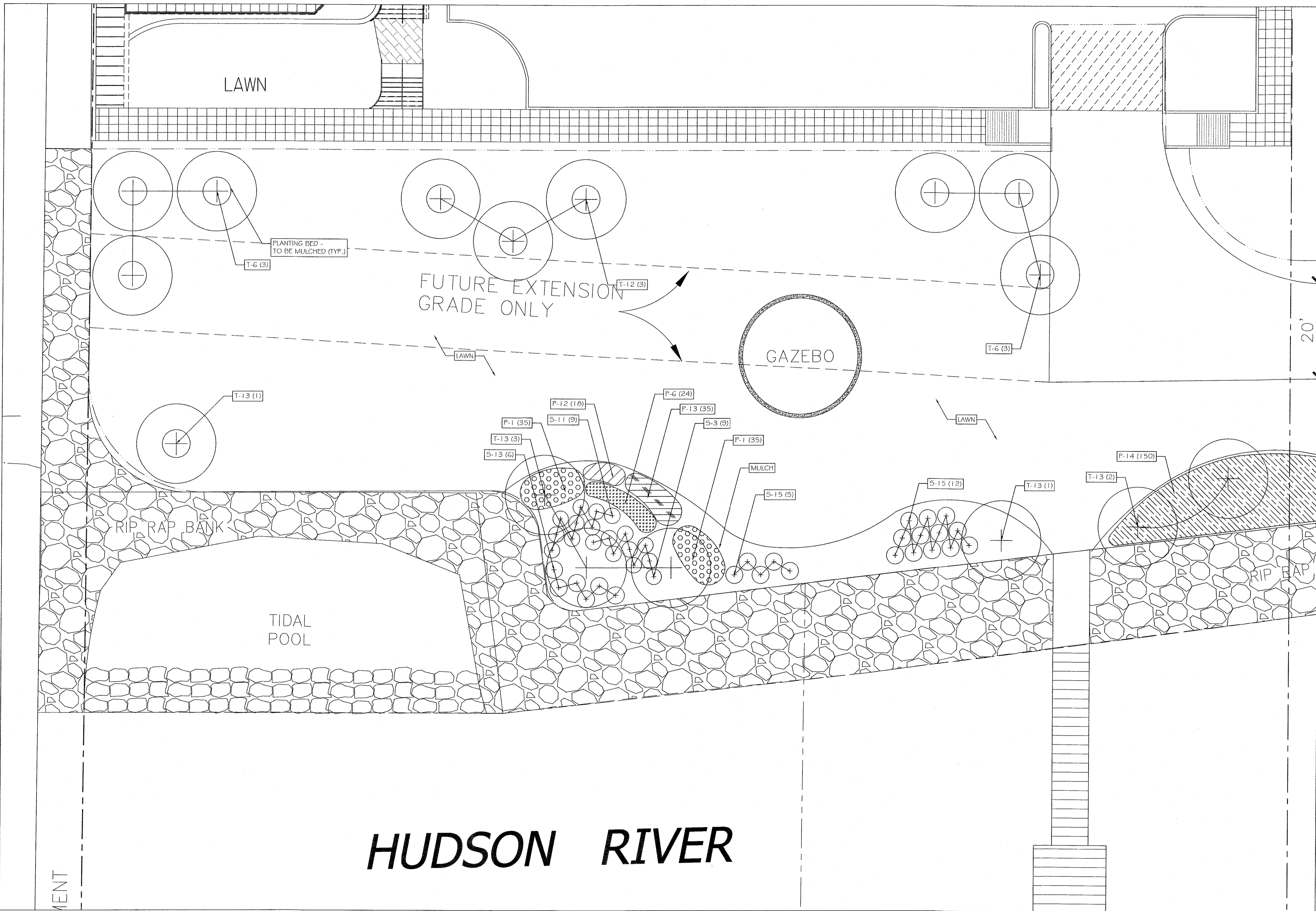

○ PLAN - WATERFRONT I - AREA I'

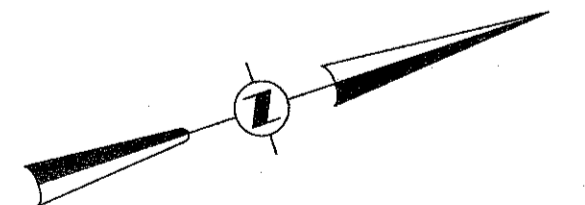

DANIEL SHERMAN  
LANDSCAPE ARCHITECT  
4 BROADWAY - SUITE 9  
VALHALLA, NY 10595  
PHONE: (914) 824 - 0999  
FAX: (914) 824-0251

PROJECT:  
**EAGLE BAY**

TOWN OF STONY POINT  
ROCKLAND COUNTY, NEW YORK

TITLE:  
**LANDSCAPING PLAN  
AREA I' - SOUTH WATERFRONT**

DRAWN BY: AL  
DATE: JANUARY 28, 2021  
PROJECT NO:

CHECKED BY: DMS  
SCALE: 1 IN. = 10 FT.  
DRAWING NO:

**1407** **L-8**

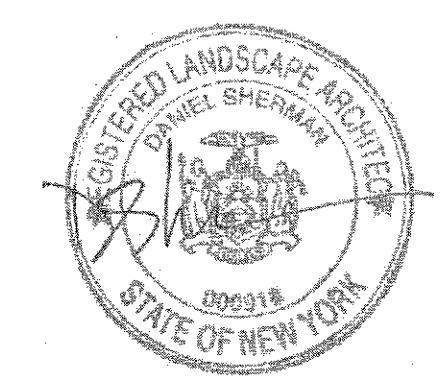

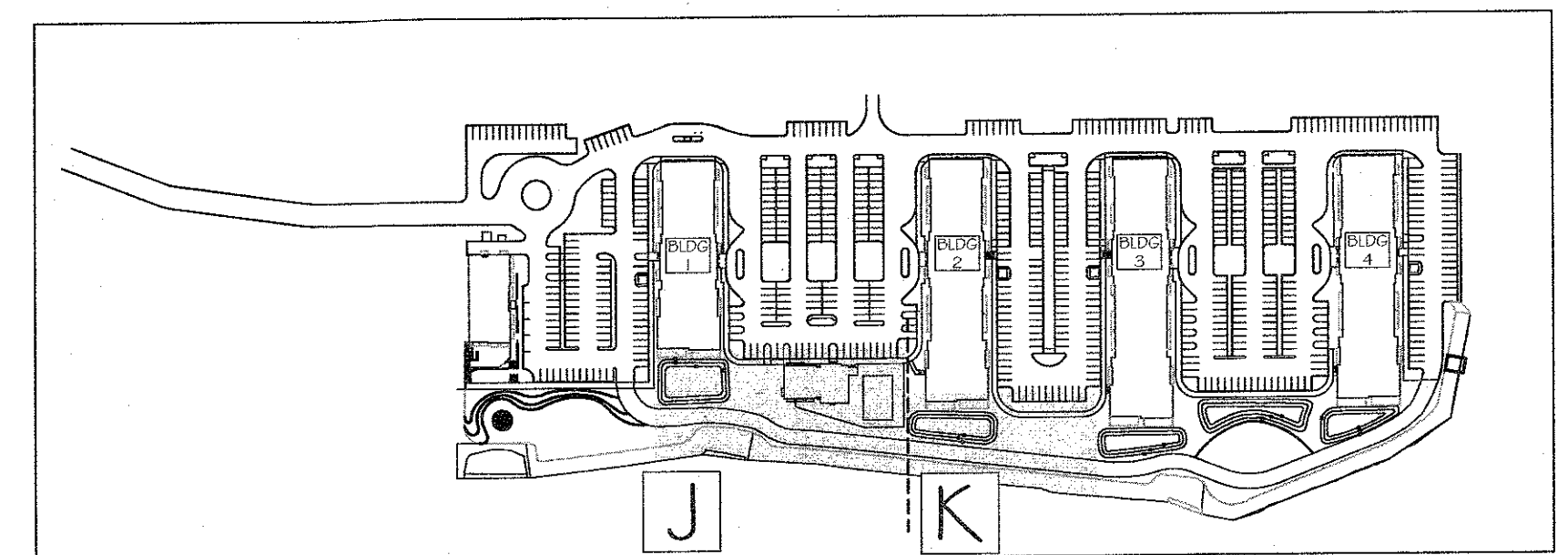
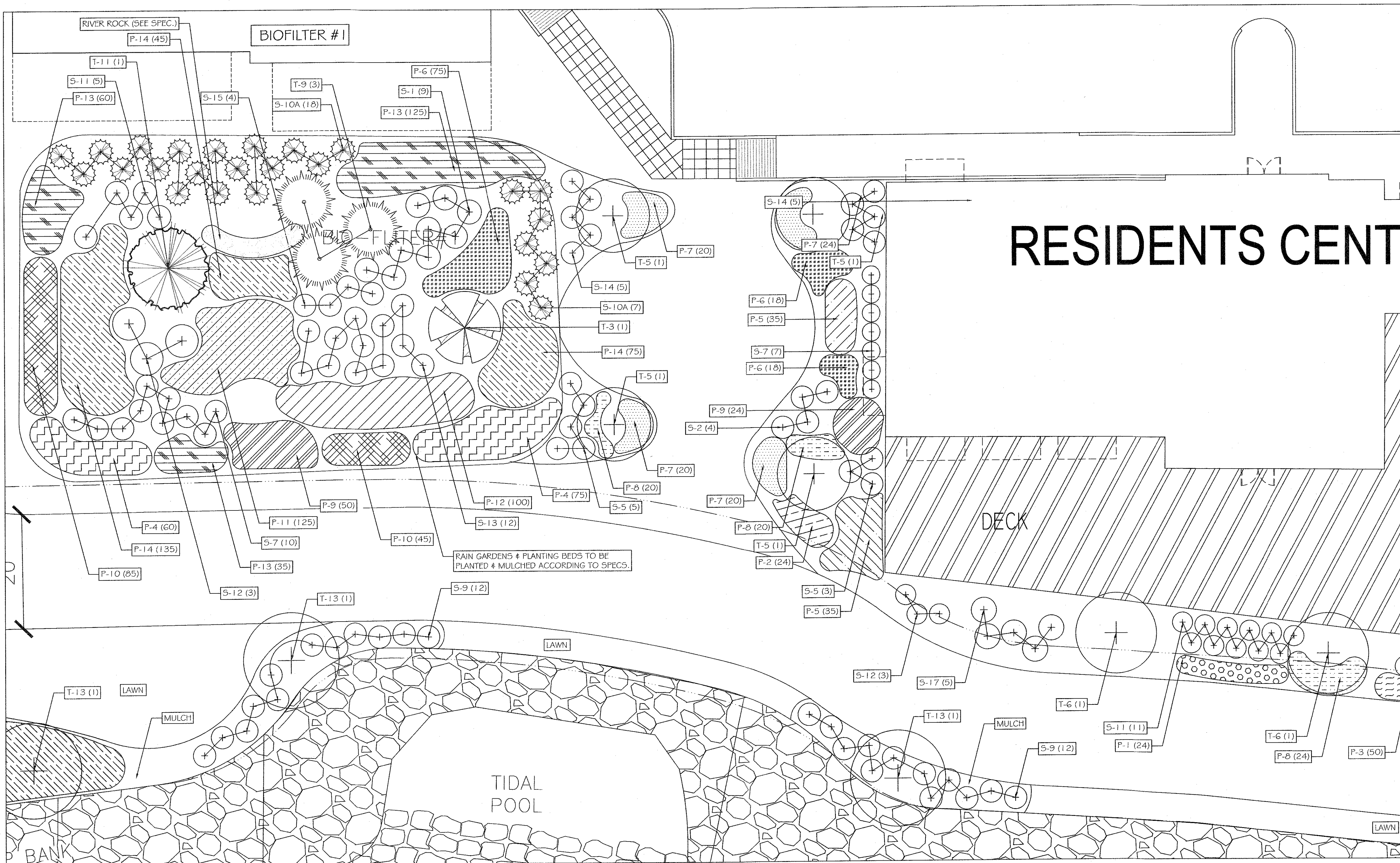

KEY PLAN  
NOT TO SCALE

Plant	Quantity	Common Name	Size	Quantity
1	1	Black Cherry	1 gal	1
2	1	Black Cherry	1 gal	1
3	1	Black Cherry	1 gal	1
4	1	Black Cherry	1 gal	1
5	1	Black Cherry	1 gal	1
6	1	Black Cherry	1 gal	1
7	1	Black Cherry	1 gal	1
8	1	Black Cherry	1 gal	1
9	1	Black Cherry	1 gal	1
10	1	Black Cherry	1 gal	1
11	1	Black Cherry	1 gal	1
12	1	Black Cherry	1 gal	1
13	1	Black Cherry	1 gal	1
14	1	Black Cherry	1 gal	1
15	1	Black Cherry	1 gal	1
16	1	Black Cherry	1 gal	1
17	1	Black Cherry	1 gal	1
18	1	Black Cherry	1 gal	1
19	1	Black Cherry	1 gal	1
20	1	Black Cherry	1 gal	1
21	1	Black Cherry	1 gal	1
22	1	Black Cherry	1 gal	1
23	1	Black Cherry	1 gal	1
24	1	Black Cherry	1 gal	1
25	1	Black Cherry	1 gal	1
26	1	Black Cherry	1 gal	1
27	1	Black Cherry	1 gal	1
28	1	Black Cherry	1 gal	1
29	1	Black Cherry	1 gal	1
30	1	Black Cherry	1 gal	1
31	1	Black Cherry	1 gal	1
32	1	Black Cherry	1 gal	1
33	1	Black Cherry	1 gal	1
34	1	Black Cherry	1 gal	1
35	1	Black Cherry	1 gal	1
36	1	Black Cherry	1 gal	1
37	1	Black Cherry	1 gal	1
38	1	Black Cherry	1 gal	1
39	1	Black Cherry	1 gal	1
40	1	Black Cherry	1 gal	1
41	1	Black Cherry	1 gal	1
42	1	Black Cherry	1 gal	1
43	1	Black Cherry	1 gal	1
44	1	Black Cherry	1 gal	1
45	1	Black Cherry	1 gal	1
46	1	Black Cherry	1 gal	1
47	1	Black Cherry	1 gal	1
48	1	Black Cherry	1 gal	1
49	1	Black Cherry	1 gal	1
50	1	Black Cherry	1 gal	1
51	1	Black Cherry	1 gal	1
52	1	Black Cherry	1 gal	1
53	1	Black Cherry	1 gal	1
54	1	Black Cherry	1 gal	1
55	1	Black Cherry	1 gal	1
56	1	Black Cherry	1 gal	1
57	1	Black Cherry	1 gal	1
58	1	Black Cherry	1 gal	1
59	1	Black Cherry	1 gal	1
60	1	Black Cherry	1 gal	1
61	1	Black Cherry	1 gal	1
62	1	Black Cherry	1 gal	1
63	1	Black Cherry	1 gal	1
64	1	Black Cherry	1 gal	1
65	1	Black Cherry	1 gal	1
66	1	Black Cherry	1 gal	1
67	1	Black Cherry	1 gal	1
68	1	Black Cherry	1 gal	1
69	1	Black Cherry	1 gal	1
70	1	Black Cherry	1 gal	1
71	1	Black Cherry	1 gal	1
72	1	Black Cherry	1 gal	1
73	1	Black Cherry	1 gal	1
74	1	Black Cherry	1 gal	1
75	1	Black Cherry	1 gal	1
76	1	Black Cherry	1 gal	1
77	1	Black Cherry	1 gal	1
78	1	Black Cherry	1 gal	1
79	1	Black Cherry	1 gal	1
80	1	Black Cherry	1 gal	1
81	1	Black Cherry	1 gal	1
82	1	Black Cherry	1 gal	1
83	1	Black Cherry	1 gal	1
84	1	Black Cherry	1 gal	1
85	1	Black Cherry	1 gal	1
86	1	Black Cherry	1 gal	1
87	1	Black Cherry	1 gal	1
88	1	Black Cherry	1 gal	1
89	1	Black Cherry	1 gal	1
90	1	Black Cherry	1 gal	1
91	1	Black Cherry	1 gal	1
92	1	Black Cherry	1 gal	1
93	1	Black Cherry	1 gal	1
94	1	Black Cherry	1 gal	1
95	1	Black Cherry	1 gal	1
96	1	Black Cherry	1 gal	1
97	1	Black Cherry	1 gal	1
98	1	Black Cherry	1 gal	1
99	1	Black Cherry	1 gal	1
100	1	Black Cherry	1 gal	1

Plant	Quantity	Common Name	Size	Quantity
1	1	Black Cherry	1 gal	1
2	1	Black Cherry	1 gal	1
3	1	Black Cherry	1 gal	1
4	1	Black Cherry	1 gal	1
5	1	Black Cherry	1 gal	1
6	1	Black Cherry	1 gal	1
7	1	Black Cherry	1 gal	1
8	1	Black Cherry	1 gal	1
9	1	Black Cherry	1 gal	1
10	1	Black Cherry	1 gal	1
11	1	Black Cherry	1 gal	1
12	1	Black Cherry	1 gal	1
13	1	Black Cherry	1 gal	1
14	1	Black Cherry	1 gal	1
15	1	Black Cherry	1 gal	1
16	1	Black Cherry	1 gal	1
17	1	Black Cherry	1 gal	1
18	1	Black Cherry	1 gal	1
19	1	Black Cherry	1 gal	1
20	1	Black Cherry	1 gal	1
21	1	Black Cherry	1 gal	1
22	1	Black Cherry	1 gal	1
23	1	Black Cherry	1 gal	1
24	1	Black Cherry	1 gal	1
25	1	Black Cherry	1 gal	1
26	1	Black Cherry	1 gal	1
27	1	Black Cherry	1 gal	1
28	1	Black Cherry	1 gal	1
29	1	Black Cherry	1 gal	1
30	1	Black Cherry	1 gal	1
31	1	Black Cherry	1 gal	1
32	1	Black Cherry	1 gal	1
33	1	Black Cherry	1 gal	1
34	1	Black Cherry	1 gal	1
35	1	Black Cherry	1 gal	1
36	1	Black Cherry	1 gal	1
37	1	Black Cherry	1 gal	1
38	1	Black Cherry	1 gal	1
39	1	Black Cherry	1 gal	1
40	1	Black Cherry	1 gal	1
41	1	Black Cherry	1 gal	1
42	1	Black Cherry	1 gal	1
43	1	Black Cherry	1 gal	1
44	1	Black Cherry	1 gal	1
45	1	Black Cherry	1 gal	1
46	1	Black Cherry	1 gal	1
47	1	Black Cherry	1 gal	1
48	1	Black Cherry	1 gal	1
49	1	Black Cherry	1 gal	1
50	1	Black Cherry	1 gal	1
51	1	Black Cherry	1 gal	1
52	1	Black Cherry	1 gal	1
53	1	Black Cherry	1 gal	1
54	1	Black Cherry	1 gal	1
55	1	Black Cherry	1 gal	1
56	1	Black Cherry	1 gal	1
57	1	Black Cherry	1 gal	1
58	1	Black Cherry	1 gal	1
59	1	Black Cherry	1 gal	1
60	1	Black Cherry	1 gal	1
61	1	Black Cherry	1 gal	1
62	1	Black Cherry	1 gal	1
63	1	Black Cherry	1 gal	1
64	1	Black Cherry	1 gal	1
65	1	Black Cherry	1 gal	1
66	1	Black Cherry	1 gal	1
67	1	Black Cherry	1 gal	1
68	1	Black Cherry	1 gal	1
69	1	Black Cherry	1 gal	1
70	1	Black Cherry	1 gal	1
71	1	Black Cherry	1 gal	1
72	1	Black Cherry	1 gal	1
73	1	Black Cherry	1 gal	1
74	1	Black Cherry	1 gal	1
75	1	Black Cherry	1 gal	1
76	1	Black Cherry	1 gal	1
77	1	Black Cherry	1 gal	1
78	1	Black Cherry	1 gal	1
79	1	Black Cherry	1 gal	1
80	1	Black Cherry	1 gal	1
81	1	Black Cherry	1 gal	1
82	1	Black Cherry	1 gal	1
83	1	Black Cherry	1 gal	1
84	1	Black Cherry	1 gal	1
85	1	Black Cherry	1 gal	1
86	1	Black Cherry	1 gal	1
87	1	Black Cherry	1 gal	1
88	1	Black Cherry	1 gal	1
89	1	Black Cherry	1 gal	1
90	1	Black Cherry	1 gal	1
91	1	Black Cherry	1 gal	1
92	1	Black Cherry	1 gal	1
93	1	Black Cherry	1 gal	1
94	1	Black Cherry	1 gal	1
95	1	Black Cherry	1 gal	1
96	1	Black Cherry	1 gal	1
97	1	Black Cherry	1 gal	1
98	1	Black Cherry	1 gal	1
99	1	Black Cherry	1 gal	1
100	1	Black Cherry	1 gal	1

PLAN - WATERFRONT 2 - AREA 'J'

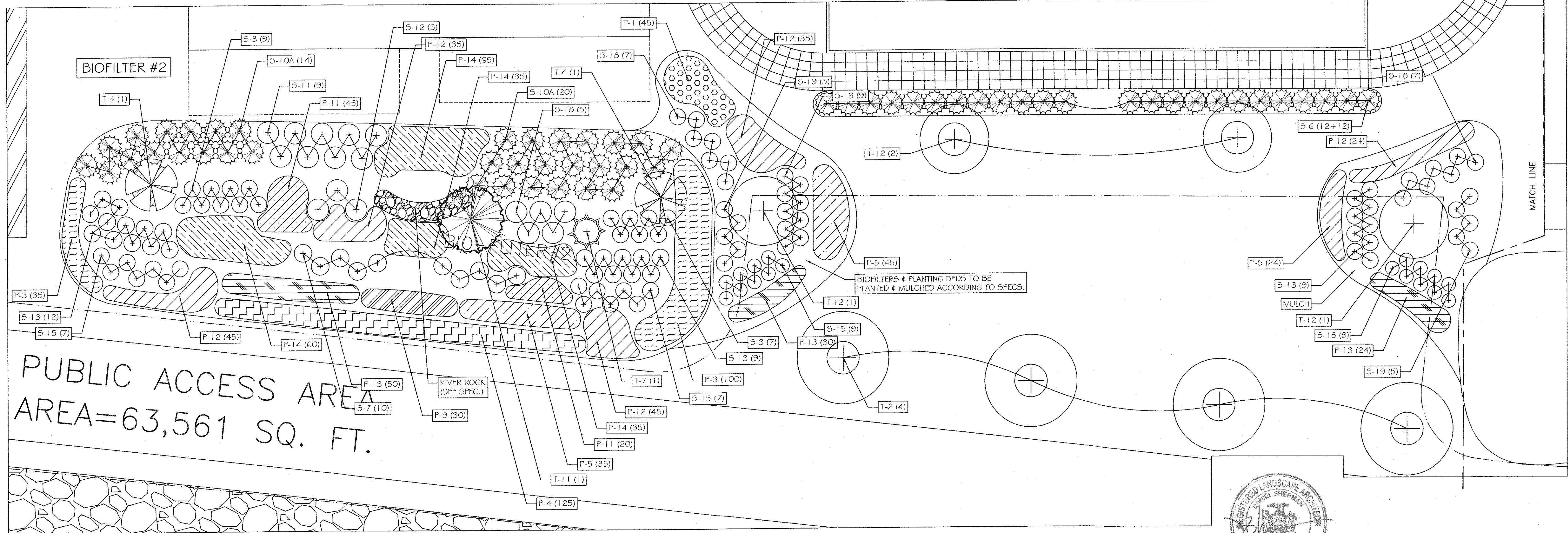

PLAN - WATERFRONT 3 - AREA 'K'

DANIEL SHERMAN  
LANDSCAPE ARCHITECT  
4 BROADWAY - SUITE 9  
VALHALLA, NY 10955  
PHONE: (914) 824 - 0999  
FAX: (914) 824-0251

PROJECT:  
**EAGLE BAY**

TOWN OF STONY POINT  
ROCKLAND COUNTY, NEW YORK

TITLE:  
**LANDSCAPING PLAN  
AREA 'J' & 'K' - CENTRAL WATERFRONT**

DRAWN BY: AL  
DATE: JANUARY 28, 2021  
PROJECT NO: 1407

CHECKED BY: DMS  
SCALE: 1 IN. = 10 FT.  
DRAWING NO: L-9

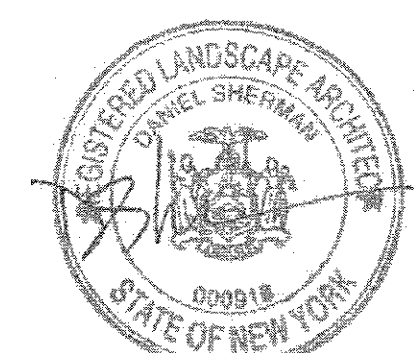



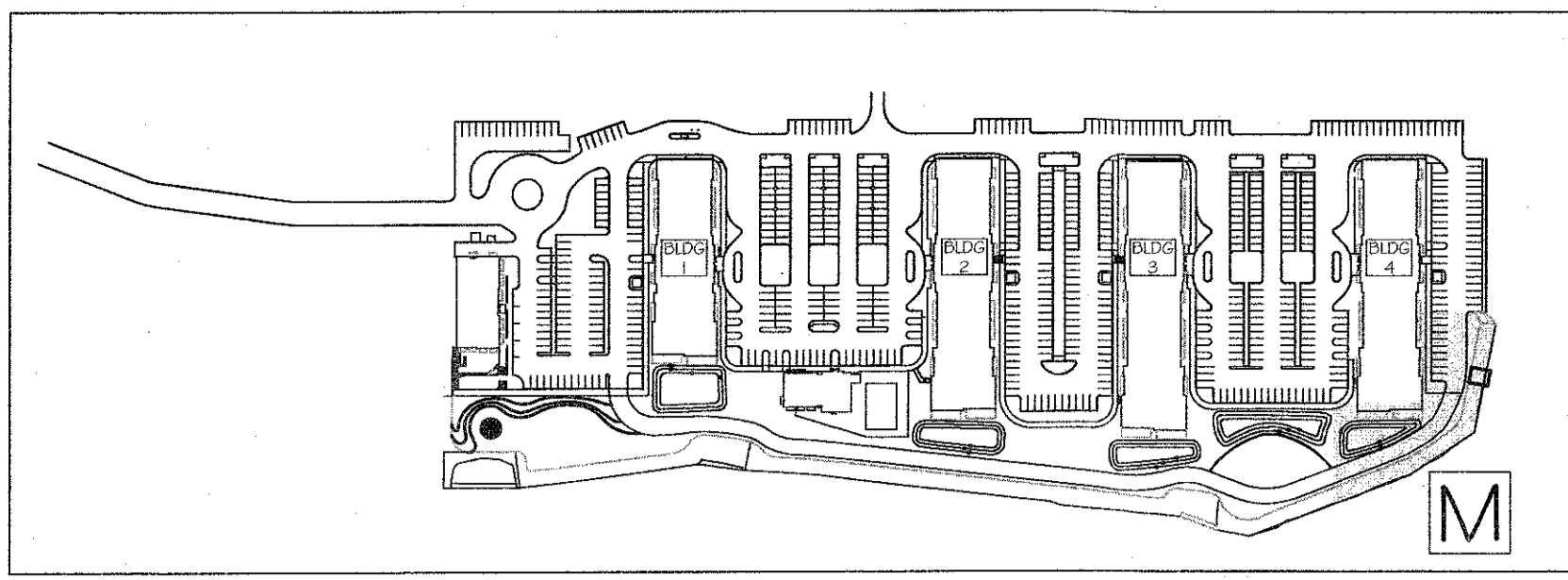

KEY PLAN  
NOT TO SCALE

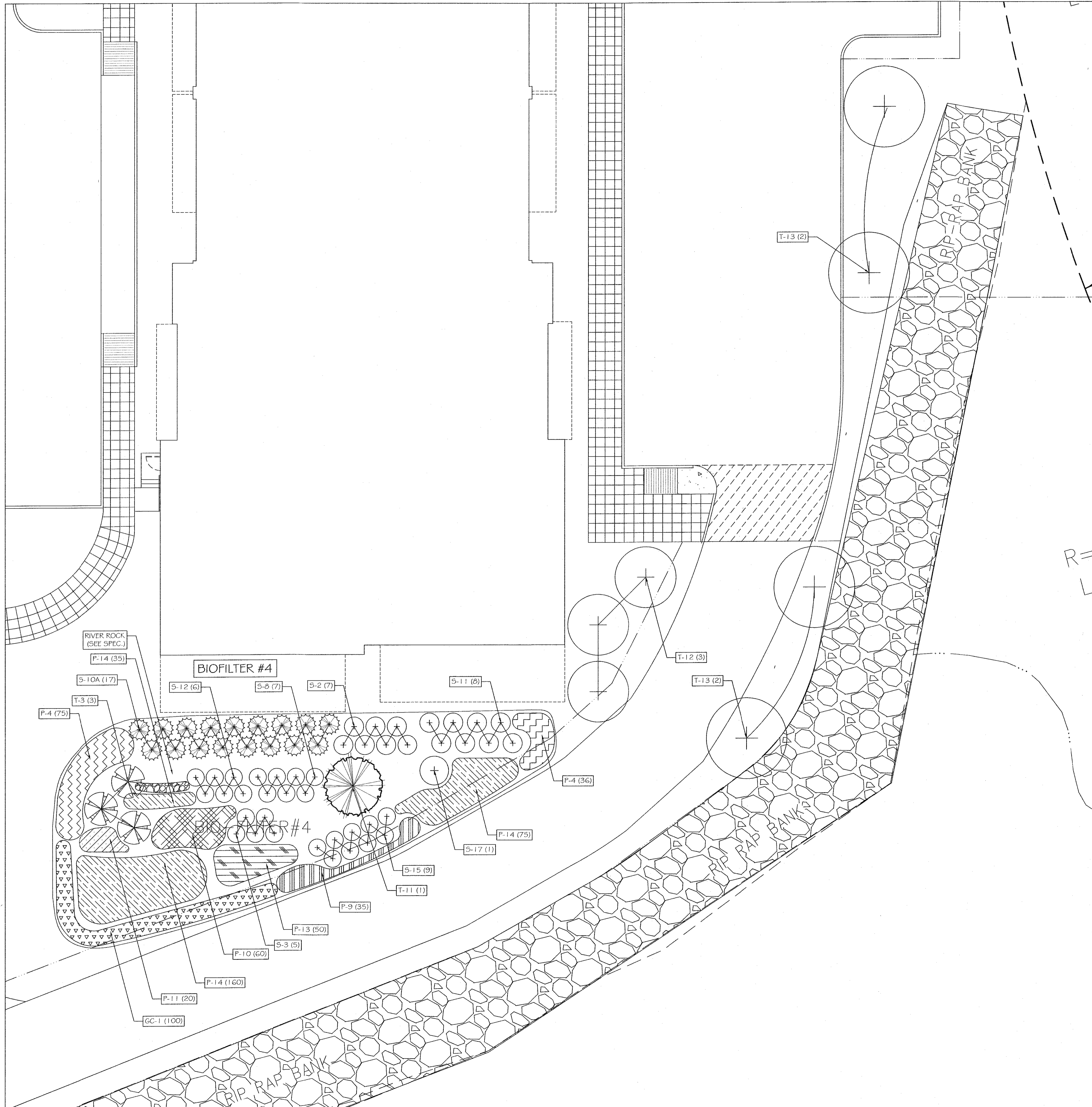

PLAN - WATERFRONT 5 - AREA 'M'

Landscape Sheet L-11 - Biofilter #4				
Key	Scientific Name	Common Name	Size	Quantity
<b>Trees</b>				
T3	<i>Amelanchier canadensis</i>	Shadblow Serviceberry	8'-10' ht.	3
T11	<i>Pinus rigida</i>	Pitch Pine	8'-10' ht.	1
<b>Shrubs</b>				
S2	<i>Cephalanthus occidentalis</i>	Button Bush	5 gal.	7
S3	<i>Cornus sericea</i>	Red Twig Dogwood	5 gal.	5
S8	<i>Ilex verticillata</i>	Winterberry	3'-4' ht.	7
S10a	<i>Juniperus chinensis 'sargentii'</i>	Sargent Juniper	3 gal.	17
S11	<i>Myrica pennsylvanica</i>	Bayberry	5 gal.	8
S12	<i>Physocarpus opulifolius 'Diabolo'</i>	Ninebark	7 gal.	6
S16	<i>Rosa carolina</i>	Pasture Rose	5 gal.	9
S17	<i>Viburnum dentatum</i>	Arrowwood Viburnum	7 gal.	1
<b>Perennials</b>				
P4	<i>Carex platyphylla</i>	Broad-Leaf Sedge	1 gal.	111
P9	<i>Iris versicolor</i>	Blue Flag Iris	1 gal.	35
P10	<i>Liatris spicata</i>	Blazing Star	1 gal.	60
P11	<i>Hemerocallis distylis</i>	Scarlet Bealbm, Osergo Tea	1 gal.	20
P13	<i>Rudbeckia hirta</i>	Black Eye Susans	1 gal.	50
P14	<i>Urtica paniculata</i>	Sea Oats	1 gal.	270
<b>Ground Covers</b>				
GC1	<i>Arcostaphylos uvaursi</i>	Bear Berry	4" pots	100

Landscape Sheet L-11 - Waterfront - Area M				
Key	Scientific Name	Common Name	Size	Quantity
<b>Trees</b>				
T12	<i>Platanus occidentalis</i>	American Sycamore	2.5'-3' cal.	3
T13	<i>Quercus bicolor</i>	Swamp White Oak	2.5'-3' cal.	4

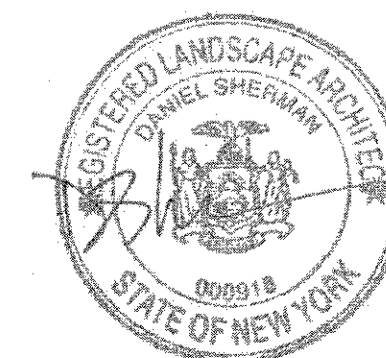

DANIEL SHERMAN  
LANDSCAPE ARCHITECT  
4 BROADWAY - SUITE 9  
VALHALLA, NY 10595  
PHONE: (914) 824 - 0999  
FAX: (914) 824-0251

PROJECT: **EAGLE BAY**

TOWN OF STONY POINT  
ROCKLAND COUNTY, NEW YORK

TITLE: **LANDSCAPING PLAN  
AREA 'M' - NORTH WATERFRONT 2**

DRAWN BY: AL      CHECKED BY: DMS  
DATE: JANUARY 28, 2021      SCALE: 1 IN. = 10 FT.  
PROJECT NO:      DRAWING NO:

**1407**      **L-11**